

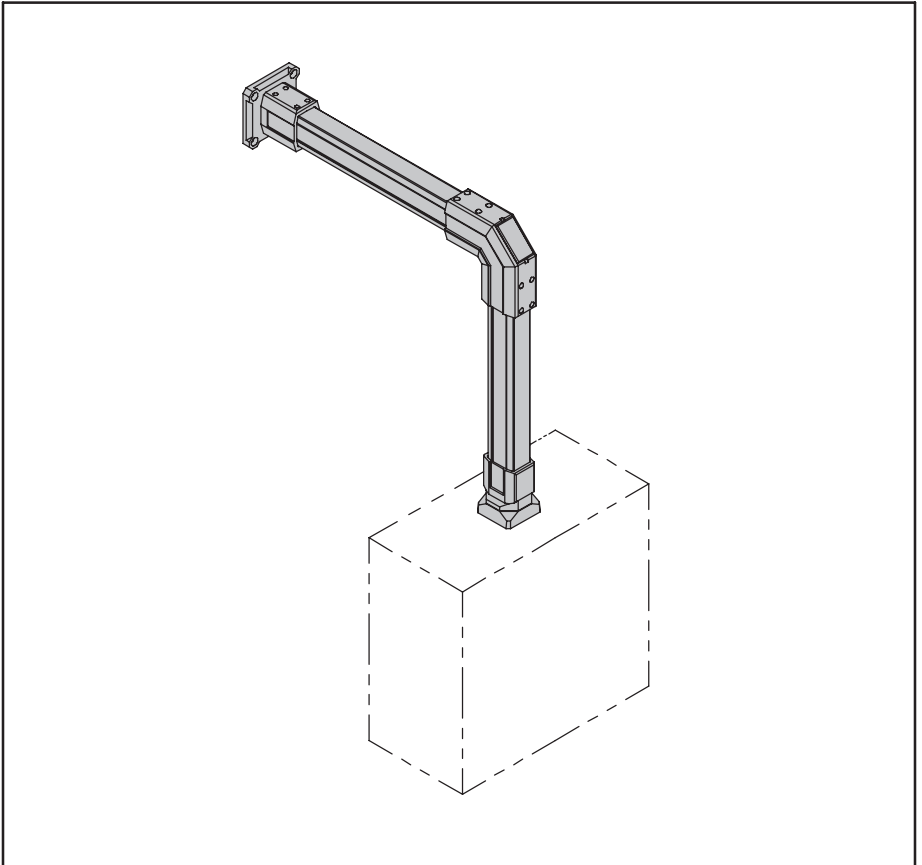

HOFFMAN

Compact

Pendant Arm Series 2
Tragarmsystem Serie 2
Système de suspension série
Sistema de suspensión



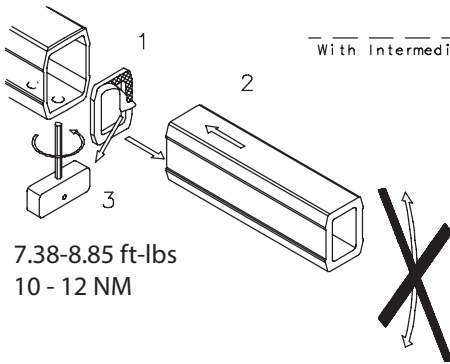

7.38-8.85 ft-lbs
10 - 12 NM

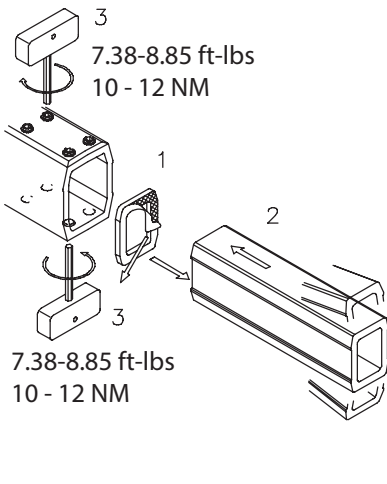
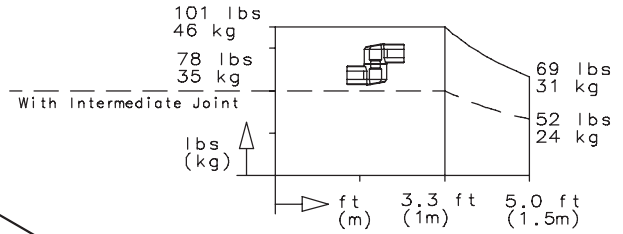

7.38-8.85 ft-lbs
10 - 12 NM

7.38-8.85 ft-lbs
10 - 12 NM

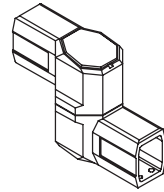

CCS2IJLG

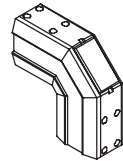
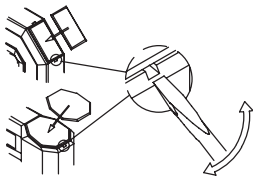

CCS2EHDLG

Base Mounting Cutout
Niedriger Montage-Ausschnitt
Coupe-circuit Bas De Support
Recorte Bajo Del Montaje

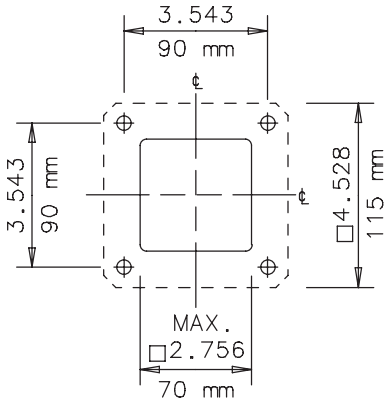

For continuous conductivity please place serrated lock washer according DIN 6798-A 8,4 (part not included) under fastening screw head.

Für durchgängige Leitfähigkeit Fächerscheibe DIN 6798-A 8,4 (nicht im Lieferumfang enthalten) unter Befestigungsschraubenkopf legen.

Pour la conductivité continue, placer la rondelle dentelée selon DIN 6798-A 8,4 (pièce non incluse) sous la tête de la vis de fixation.

Para conductividad continua, coloque la arandela de seguridad dentada según el DIN 6798-A 8,4 (no incluido) debajo de la cabeza del tornillo de fijación

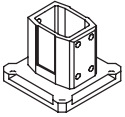

CCS2WFBLG

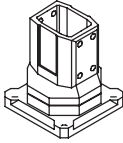

CCS2RBLG

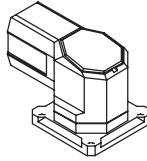

CCS2SJLG

Base Mounting Cutout
Niedriger Montage-Ausschnitt
Coupe-circuit Bas De Support
Recorte Bajo Del Montaje

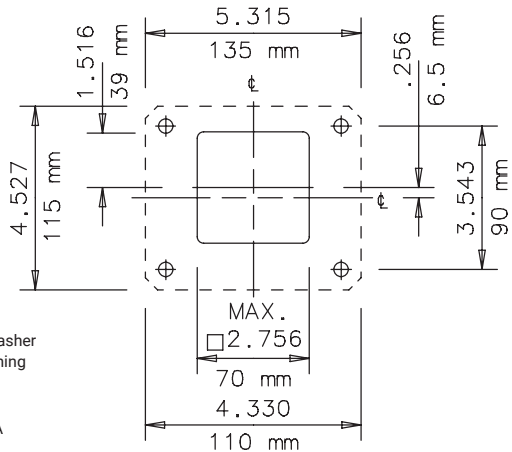

For continuous conductivity please place serrated lock washer according DIN 6798-A 8,4 (part not included) under fastening screw head.

Für durchgängige Leitfähigkeit Fächerscheibe DIN 6798-A 8,4 (nicht im Lieferumfang enthalten) unter Befestigungsschraubenkopf legen.

Pour la conductivité continue, placer la rondelle dentelée selon DIN 6798-A 8,4 (pièce non incluse) sous la tête de la vis de fixation.

Para conductividad continua, coloque la arandela de seguridad dentada según el DIN 6798-A 8,4 (no incluido) debajo de la cabeza del tornillo de fijación

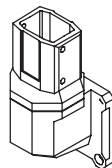

CCS2WJVLG

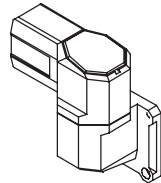

CCS2WJHLG



HOFFMAN