

FEATURES & SPECIFICATIONS

INTENDED USE

For use with housings L3 and L3R. The small aperture adjustable gimbal designed for PAR20 lamps are an excellent choice for lower installation-height applications such as soffits, casework, and niches. Ideal for hospitality, retail, residential and apartment interior spaces, such as kitchens, dining rooms, bedrooms, and lounge areas.

CONSTRUCTION

Durable powder-coated steel finishing trim.
 Directional accent lighting gimbal ring available in matte white and matte black finishes.
 35° vertical tilt standard.
 180° horizontal rotation.

INSTALLATION

Socket to trim interface.
 Retaining clips attached to trim ring hold trim inside housing.

LISTINGS

cETLus listed to U.S. and Canadian safety standards.

Damp location listed.

WARRANTY

1-year limited warranty. This is the only warranty provided and no other statements in this specification sheet create any warranty of any kind. All other express and implied warranties are disclaimed. Complete warranty terms located at:

www.acuitybrands.com/support/warranty/terms-and-conditions

Note: Actual performance may differ as a result of end-user environment and application.

Specifications subject to change without notice.

Catalog Number
Notes
Type

4" Finishing Trim

4G2 PAR



GIMBAL
Narrow Flange



Matte black

Specifications

Height: 3-3/4 (9.6) with PAR Lamp

Lamp opening: 2-1/2 (6.3)

Diameter: 5-1/8 (13.01)

All dimensions are inches (centimeters) unless otherwise indicated.

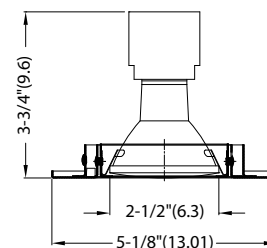

ORDERING INFORMATION

For shortest lead times, configure product using **bolded options**.

Example: 4G2MW PAR20

Series	Finish	Lamp
4G2	MW Matte white MB Matte Black	PAR20

Housing Compatibility: Housing and trim ordered separately.			
Application	Source	Maximum wattage	Housing
IC	Incandescent	50 PAR20 <i>short or long neck</i>	L3, L3R
	LED	8 PAR20	

4G2 4" Gimbal Trim

For PAR reflector lamps, see lamp manufacturer's published raw lamp data for photometrics.