

Sockets for RSLM Relays

ZRLS1 NA

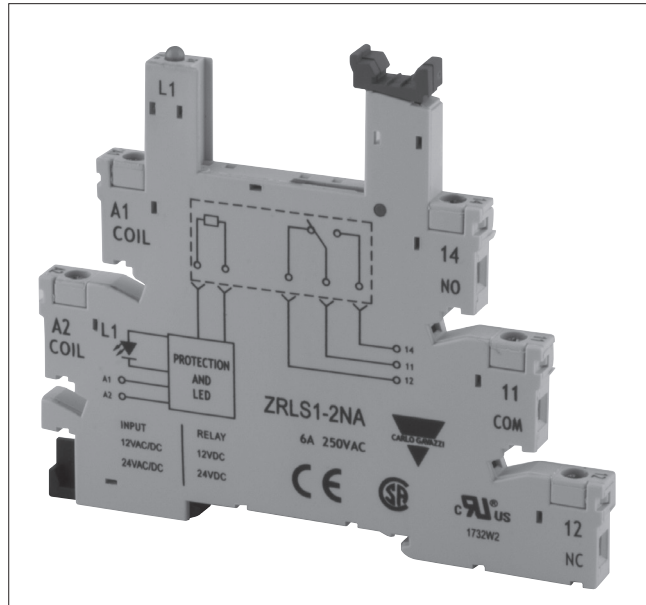

mm/inches DIMENSIONS

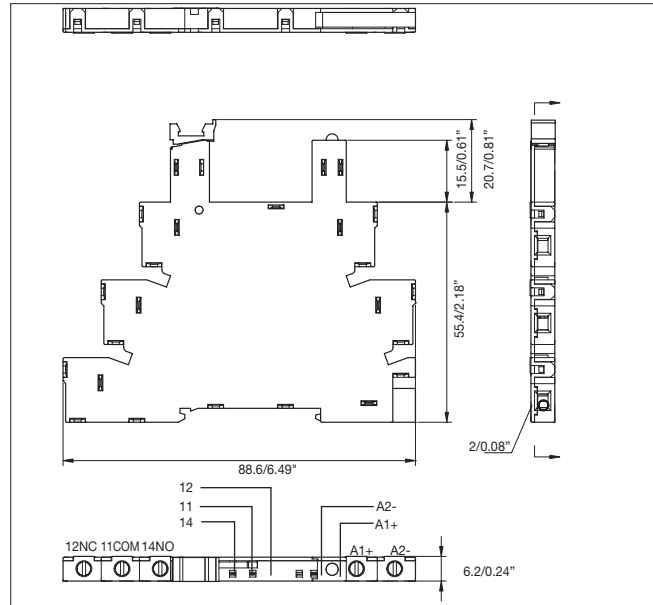

General Data

Rated voltage	250VAC
Rated current	6A
Insulation voltage	>3kV
Protection degree	IP 20 B
Socket material	PA66+GF (V0)
Socket colour	RAL 7035 / Pantone 1 C
Contacts material	CuSN 6.5-0.1
Contacts surface	Tin-plated
Terminal type	Screw cage
Operating temperature	-40° to +70°C (-40 to 158°F)
Max wire section	
Flex / Compact wire	2 x 2.5mm (14AWG)
Cable End	2 x 1.5mm (16AWG)

Input data and Ordering code

ZRLS1-2NA	
Input	6 to 24VAC/VDC
Coil rate*	6 to 24VDC
ZRLS1-3NA	
Input	48 to 60VAC/VDC
Coil rate*	48 to 60VDC
ZRLS1-4NA	
Input	110 to 125VAC/VDC
Coil rate*	60VDC
ZRLS1-5NA	
Input	220 to 240VAC/VDC
Coil rate*	60VDC

* The coil rate value is the socket output voltage. The relay to be fitted should have the same coil voltage.

Output Data

Max voltage	300VAC max
Max current	6A

Approvals



Box content: 20 sockets
Box size: 130 x 85 x 95 mm
5.1 x 3.3 x 3.7 inches
Weight: 600g
Weight: 21.16oz

Optional Accessories (to be ordered separately if required)

Labels	ZRLS-LAB
Separator	ZRLS-DIV
Bridging bar	ZRLS-BB

Sockets for RSLM Relays

ZRLS1 GA

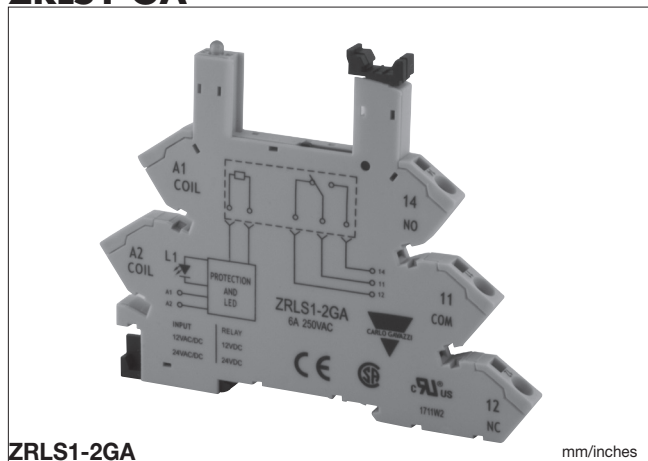

mm/inches DIMENSIONS

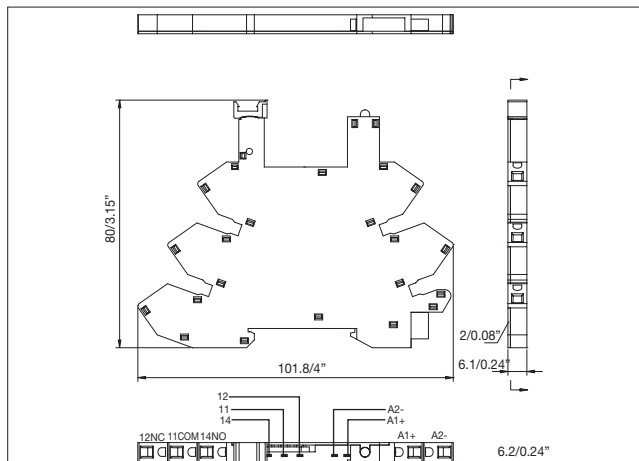

General Data

Rated voltage	250VAC
Rated current	6A
Insulation voltage	>3kV
Protection degree	IP 20 B
Socket material	PA66+GF (V0)
Socket colour	RAL 7035 / Pantone 1C
Contacts material	CuSn 6.5-0.1
Contacts surface	Tin-plated
Terminal type	Spring loaded terminal
Operating temperature	-40° to +70°C (-40 to 158°F)
Max wire section	
Flex / Compact wire	2 x 2.5mm ² (14AWG)
Cable End	2 x 1.5mm ² (16AWG)

Input data and Ordering code

ZRLS1-2GA	
Input	6 to 24VAC/VDC
Coil rate*	6 to 24VDC
ZRLS1-3GA	
Input	48 to 60VAC/VDC
Coil rate*	48 to 60VAC/VDC
ZRLS1-4GA	
Input	110 to 125VAC/VDC
Coil rate*	60VDC
ZRLS1-5GA	
Input	220 to 240VAC/VDC
Coil rate*	60VDC

* The coil rate value is the socket output voltage. The relay to be fitted should have the same coil voltage.

Output Data

Max voltage	300VAC max
Max current	6A

Approvals



Box content: 20 sockets
Box size: 130 x 85 x 95 mm
5.1 x 3.3 x 3.7 inches
Weight: 600g
Weight: 21.16oz

Optional Accessories (to be ordered separately if required)

Labels	ZRLS-LAB
Separator	ZRLS-DIV
Bridging bar	ZRLS-BB