



Door-coupling rotary operating mechanism Emergency switching-off with tolerance compensation Size 75x 75, Shaft 8x 8, 300 mm, test-0-1, Complete unit Handle size 45 mm Accessory for 3KD size 1 and 2, 3KF size 1

Model	
product brand name	SETRON
product designation	Door mounted rotary operator
design of the product	EMERGENCY OFF
design of handle	Red-yellow
design of the door lock system	Door interlocking
size of cross-section of the shaft of door-coupling rotary operating mechanism	8x8 mm
size format of the masking frame of door-coupling rotary operating mechanism	75x 75 mm
length of handle	45 mm
length of shaft of door-coupling rotary operating mechanism	300 mm
protection class IP	IP65
suitability for use	3KC0 MTSE, 3KD size 1 and 2, 3KF size 1
Product details	
product description	size 100x100 mm, shaft 8 x8 mm
product component	
• extension shaft	Yes
• handle for emergency-OFF function	Yes
product feature lockable	Yes
display version for switch position indicator	test-0-1
Mechanical Design	
height	105 mm
width	88 mm
depth	445 mm
net weight	622 g
General Product Approval	
Declaration of Conformity	
Test Certificates	



[Type Test Certificates/Test Report](#)

Marine / Shipping

other

Environment



LRS

[Confirmation](#)

[Miscellaneous](#)

[Environmental Confirmations](#)

Further information

Siemens has decided to exit the Russian market (see here).

<https://press.siemens.com/global/en/pressrelease/siemens-wind-down-russian-business>

Siemens is working on the renewal of the current EAC certificates.

Please contact your local Siemens office on the status of validity of the EAC certification if you intend to import or offer to supply these products to an EAC relevant market (other than the sanctioned EAEU member states Russia or Belarus).

Information on the packaging

<https://support.industry.siemens.com/cs/ww/en/view/109813875>

Information- and Downloadcenter (Catalogs, Brochures,...)

<http://www.siemens.com/lowvoltage/catalogs>

Industry Mall (Online ordering system)

<https://mall.industry.siemens.com/mall/en/en/Catalog/product?mlfb=8UD1171-2AF25>

Service&Support (Manuals, Certificates, Characteristics, FAQs,...)

<https://support.industry.siemens.com/cs/ww/en/ps/8UD1171-2AF25>

Image database (product images, 2D dimension drawings, 3D models, device circuit diagrams, ...)

http://www.automation.siemens.com/bilddb/cax_en.aspx?mlfb=8UD1171-2AF25

CAX-Online-Generator

<http://www.siemens.com/cax>

Tender specifications

<http://www.siemens.com/specifications>

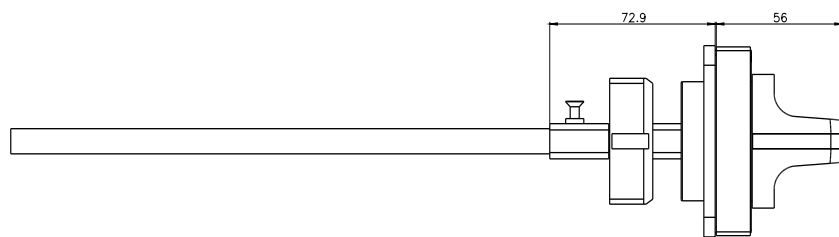
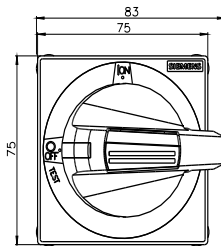

last modified:

7/29/2022 

