

THIS COPY IS PROVIDED ON A RESTRICTED BASIS AND IS NOT TO BE USED IN ANY WAY DETRIMENTAL TO THE INTERESTS OF PANDUIT CORP.

PANDUIT P/N	WEIGHT
PWBWFN**	.12 LBS/EACH (54.4g)/EACH

NOTES:

1. DIMENSIONS IN [] ARE METRIC.
2. PART INCLUDES 1 WATERFALL.
3. **= BL (BLACK POWDER COAT), WH (WHITE POWDER COAT), OR EZ (CLEAR ZINC)
4. ALL MATERIALS AND COMPONENTS USED MEET THE MATERIAL RESTRICTIONS OF RoHS (EUROPEAN DIRECTIVE 2011/65/EC ON THE RESTRICTION OF HAZARDOUS SUBSTANCES) AS PROPOSED BY THE RoHS TECHNICAL ADAPTATION COMMITTEE.
5. SEE CHART BELOW FOR WATERFALL APPLICATION.

NOMINAL WIRE BASKET WIDTH	INSTALLTION DIRECTION (SEE FIGURE BELOW)	PWBWFN**
4" (100mm)	PARALLEL	X
	PERPENDICULAR	X
6" (150mm)	PARALLEL	X
	PERPENDICULAR	X
8" (200mm)	PARALLEL	X
	PERPENDICULAR	
12" (300mm)	PARALLEL	X
	PERPENDICULAR	
18" (450mm)	PARALLEL	X
	PERPENDICULAR	
24" (600mm)	PARALLEL	X
	PERPENDICULAR	

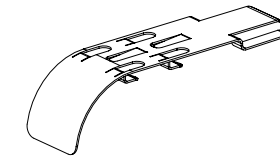
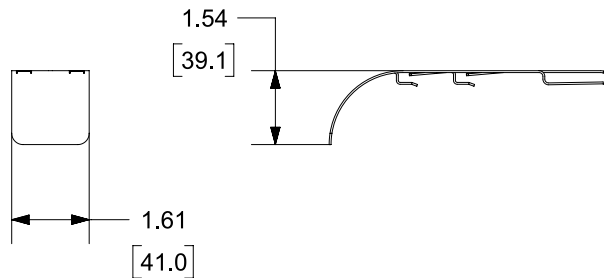
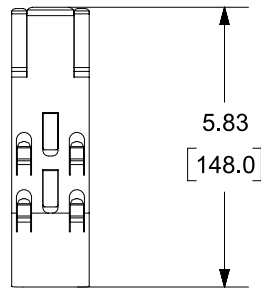

TITLE									
WIRE BASKET NARROW BOTTOM WATERFALL									
CUSTOMER DRAWING									
ITEM REVISION NAME					00510EEF/06				
DATASET FILE NAME					00510EEF_DC/06C				
					PANDUIT THIRD ANGLE PROJECTION				
DRAWING NUMBER					00510EEF - DC				
DRAWN BY		DATE		CHK		SCALE		SHEET	
JSP		6/2/21		WJM		NONE		1 OF 1	
SIZE									
A									

REV	DATE	BY	CHK	APR	DESCRIPTION	ECN
06C	12-14-23	SAT	DWR	EB	B. UPDATED TITLE. B. ADDED METRIC WIDTHS.	00510EEF-DC
06B	3/7/22	JSP	DWR	ML	A. ADD NOTE 3-5	00510EEF-DC
06A	6/2/21	JSP	WJM	ML	INITIAL RELEASE	00510EEF-DC

A-SIZE CUSTOMER