



Alcyon LED Vertical Cylinders are ideal for display, accent and task lighting and offer higher efficiency than incandescent or halogen sources leading to energy savings with no ultraviolet or infrared radiation. Alcyon provides concentrated light which dramatically draws interest to objects and elements in a space.

Project: _____
 Location: _____
 Cat.No: _____
 Type: _____
 Lamps: _____ Qty: _____
 Notes: _____

Frame-in kit

example: LLAVRM11H2120

Series	Lumens	Heads	Voltage
LLAVRM	<input type="checkbox"/>	<input type="checkbox"/>	<input type="checkbox"/>
LLAVRM Alcyon LED Recessed Vertical Cylinder	11 900 /1300lm 12 2000lm	H1 1 head H2 2 head H3 3 head H4 4 head	120 120V 277 277V

Fixture

example: LLAVRMWH1130H2

Series	Finish	Lumens	CCT	CCT	Heads
LLAVRM	<input type="checkbox"/>	<input type="checkbox"/>	<input type="checkbox"/>	<input type="checkbox"/>	<input type="checkbox"/>
LLAVRM Alcyon LED Recessed Vertical Cylinder	WH White BK Black	01 900lm 11 1300lm 12 2000lm	- 80CRI	27 2700K 30 3000K 40 4000K	H1 1 head H2 2 head H3 3 head H4 4 head

Reflector

example: LLAV12RNS

Series	Lumens	Reflector
LLAV	<input type="checkbox"/>	<input type="checkbox"/>
LLAV Alcyon LED Vertical Cylinder	11 900 /1300lm 12 2000lm	RNS Narrow Spot RS Spot RNF Narrow flood RF Flood

Accessories

example: LLA11SNBK

Series	Finish
<input type="checkbox"/>	<input type="checkbox"/>
Accessory holder with spring LLAV11AH for 900/1300lm LLAV12AH for 2000lm	WH White BK Black
Snoot LLA11SN for 900/1300lm 23SNT6 for 2000lm	WH White BK Black
Diffusion filters LLAV11 for 900/1300lm LLAV12 for 2000lm	LS Linear Spread SY Symmetrical Spread SF Soft Focus FR Frosted Etched
Color filters/gels Compatible versions provided by others for 900/1300lm ADF4 for 2000lm or Color gels provided by others	
Hex cell louver (matte black) LLAHCA11 for 900/1300lm AL4HC for 2000lm	

Assembly

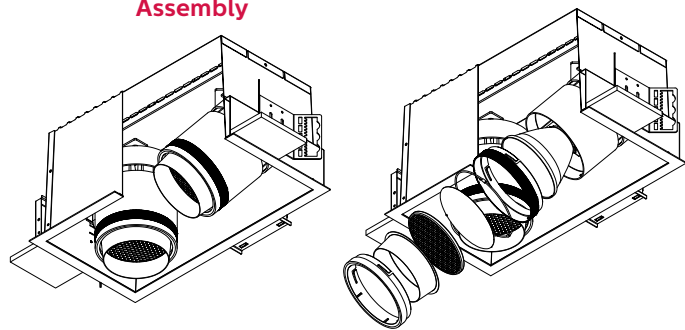

LLAVRM Alcyon LED Vertical

Recessed Multiples

900 /1300 lm

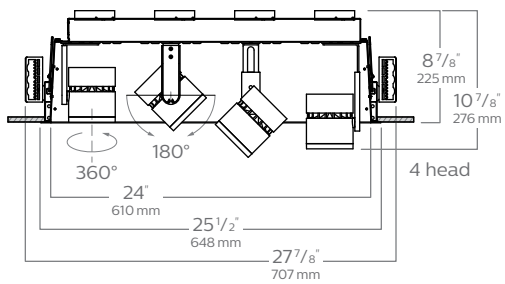
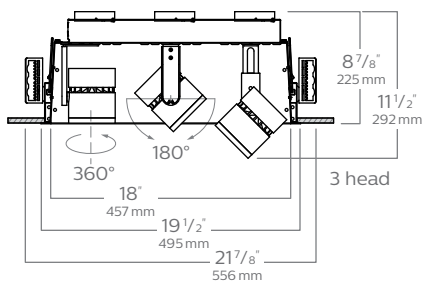
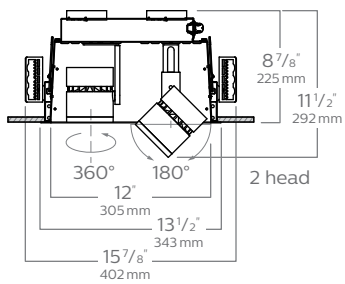
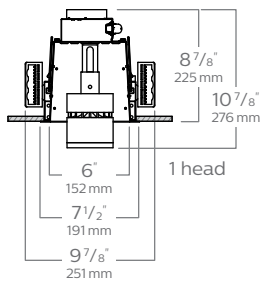
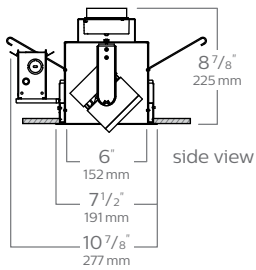

2000 lm

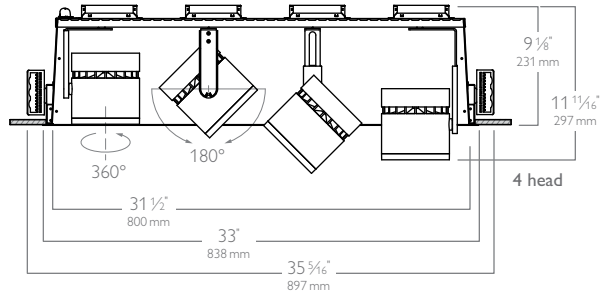
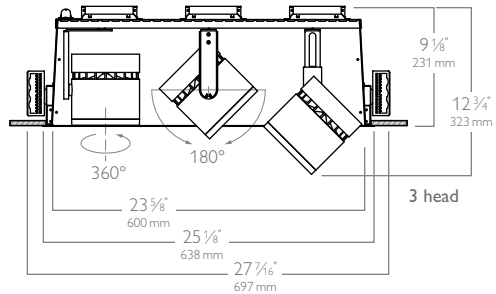
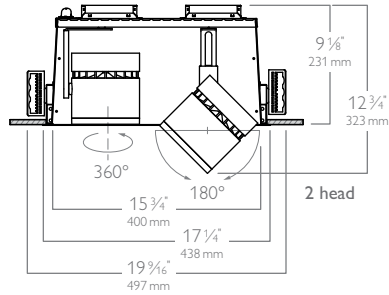
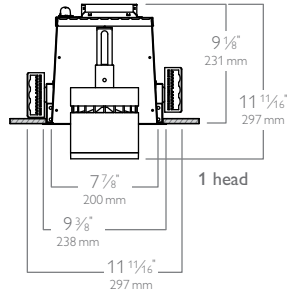
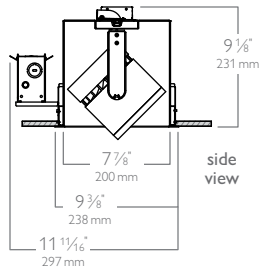

LLAVRM Alcyon LED Vertical

Recessed Multiples

Features

1. **LED Board:** COB LED.
2. **Heat Sink:** Die-cast aluminum maintains LED junction temperature for minimum 50,000hr lifetime at 70% lumen maintenance.
3. **Finishes:** Painted finishes with a baked enamel. Contains some powder coated finishes.
4. **Heat Sink Arm:** Tool-less aiming with 360° horizontal rotation, 180° vertical tilt and a pull down adjustment from flush recessed to semi-recessed for optimal performance.
5. **Trim/Housing:** One part integrated system including a seamless flange (16 ga powder coated steel), and pre-formed housing (22 ga powder coated steel), with pre-wired integral driver(s).
6. **Frame with mounting brackets:** Mounting brackets are adjustable vertically from inside of Frame-in-kit. Maximum ceiling thickness is 1 5/8". Accepts various types of mounting bars including C-channel, EMT (contractor supplied) and Lightolier mounting bars (Cat. # 1950 or 1951). For use in T-grid or sheet rock ceiling. See page 2 for overall dimensions.
7. **Junction box:** 4" x 3 1/2" x 2" ; .063" (14ga.) galvanized steel.
8. **Thermal Protector:** Meets NEC and UL requirements. Insulation must be kept 3" away from fixture sides and wiring compartments and must not be placed above fixture in a manner which will entrap heat.
9. **Luminaire Disconnect:** Power from Frame-in-kit to Trim/Housing connection with quick connect plug.
10. **Torsion Springs and Safety Springs:** Torsion Springs swivel to allow Trim/Housing to hang temporarily from one end to ease the process of making luminaire electrical connection complete. Safety Springs allow positive lock between Trim/Housing and Frame-in-kit for added security.
11. **Interchangeable Optics:** High efficiency metalized coating providing up to 98% total reflectivity for optimal light quality, beam control and punch. Reflector has lens attached which protects reflector finish and LEDs from contamination. Tool-less installation. Reflector sold separately to allow field replacement. Various combinations of beam angles could be achieved with 4 optic offerings.

Dimming

10W / 900lm: 0-10V dimming compatible.
15W / 1300lm: 0-10V dimming compatible.
21W / 2000lm: 0-10V dimming compatible.

Electrical

Electronic power supply
Input voltage: 120/277V, 50/60Hz
Input power:
900lm: 10W
1300lm: 15W
2000lm: 21W
High power factor: >0.9
CRI: 80-85 (typical)

Labels

cULus Listed.
Suitable for damp location.
ENERGY STAR® certified (pending for 2000lm).
Accessories are not Energy Star qualified.
5 year warranty.

Accessories



Alcyon LED track lighting offers a full range of high performance accessories for tinting, coloring and shaping of the light beam. All accessories are designed to attach easily. A complete accessory consists of a size and series suffix.

Components

1. Frame-in kit
2. Trim kit
3. Reflector kit
4. Accessory holder*
5. Accessory spring*
6. Diffusion filter
7. Hex cell louver
8. Snoot
9. Aperture ring

* Accessory holder includes accessory spring (shown to left).

Diffusion/special filters

LLAV11 = 3 1/8" dia.
LLAV12 = 4 3/4" dia.

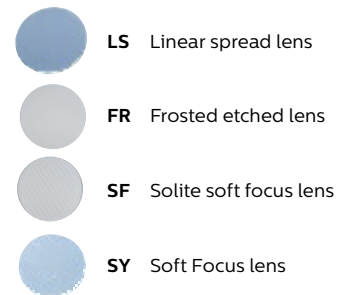

Hex cell louvers

LLAHCA11 = 3 1/8" dia.
AL4HC = 4 3/4" dia.

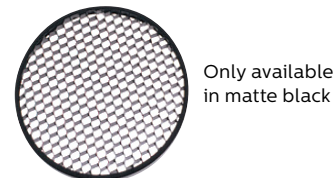

Only available in matte black

LLAVRM Alcyon LED Vertical

Recessed Multiples

Aiming angles

L and W are the outer points where the candle power drops to 50% of the maximum. FC are the initial footcandles at the center of the beam. Data shown is for 3000K, for 2700K multiply FC by 0.91.

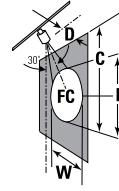
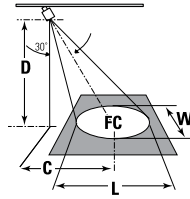

- L Beam length
- D Distance
- W Beam Width
- A Aiming Angle
- FC Footcandles
- C Distance to center beam
- CBCP Center Beam Candlepower.

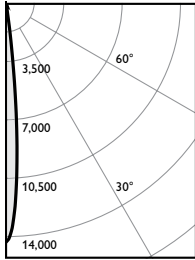

Frame: LLAVRM11H120
Fixture: LLAVRMBK0130H1
Reflector: LLAV11RNS

CCT¹: 3000K
 Output lumens: 935 lms
 Input watts²: 10.1W
 Efficacy: 92.6lm/w
 CRI: 80 min
 CBCP.: 14,350 cd
 Beam Angle: 11°
 Field Angle: 21°
 Report no³: I147GFR

Narrow Spot 30° Horizontal Aiming

Distance		F.C.	Beam	
D	C		L	W
6	3.5	259	1.5	1.3
8	4.6	146	2.1	1.8
10	5.8	93	2.6	2.2
12	6.9	65	3.1	2.7

30° Horizontal Aiming

Distance		F.C.	Beam	
D	C		L	W
2	3.5	448	1.6	0.8
3	5.2	199	2.4	1.2
4	6.9	112	3.2	1.5
5	8.7	72	4.0	1.9

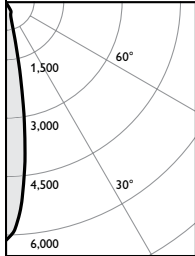

Frame: LLAVRM11H120
Fixture: LLAVRMBK0130H1
Reflector: LLAV11RS

CCT¹: 3000K
 Output lumens: 950 lms
 Input watts²: 10.1W
 Efficacy: 94.1lm/w
 CRI: 80 min
 CBCP.: 6,154 cd
 Beam Angle: 19°
 Field Angle: 35°
 Report no³: I148GFR

Spot 30° Horizontal Aiming

Distance		F.C.	Beam	
D	C		L	W
6	3.5	111	2.7	2.3
8	4.6	62	3.6	3.1
10	5.8	40	4.5	3.9
12	6.9	28	5.4	4.6

30° Horizontal Aiming

Distance		F.C.	Beam	
D	C		L	W
2	3.5	192	2.9	1.3
3	5.2	85	4.4	2.0
4	6.9	48	5.8	2.7
5	8.7	31	7.3	3.3

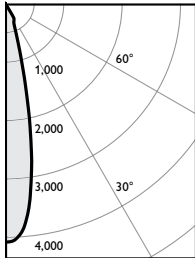

Frame: LLAVRM11H120
Fixture: LLAVRMBK0130H1
Reflector: LLAV11RNF

CCT¹: 3000K
 Output lumens: 934 lms
 Input watts²: 10.0W
 Efficacy: 93.4lm/w
 CRI: 80 min
 CBCP.: 4,069 cd
 Beam Angle: 24°
 Field Angle: 47°
 Report no³: I149GFR

Narrow Flood 30° Horizontal Aiming

Distance		F.C.	Beam	
D	C		L	W
6	3.5	73	3.5	2.9
8	4.6	41	4.6	3.9
10	5.8	26	5.8	4.9
12	6.9	18	6.9	5.9

30° Horizontal Aiming

Distance		F.C.	Beam	
D	C		L	W
2	3.5	127	3.9	1.7
3	5.2	57	5.9	2.6
4	6.9	32	7.9	3.4
5	8.7	20	9.8	4.3

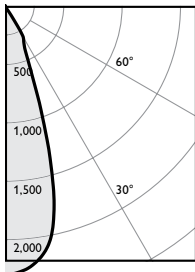

Frame: LLAVRM11H120
Fixture: LLAVRMBK0130H1
Reflector: LLAV11RF

CCT¹: 3000K
 Output lumens: 929 lms
 Input watts²: 10.0W
 Efficacy: 92.9lm/w
 CRI: 80 min
 CBCP.: 2,290 cd
 Beam Angle: 36°
 Field Angle: 63°
 Report no³: I150GFR

Flood 30° Horizontal Aiming

Distance		F.C.	Beam	
D	C		L	W
6	3.5	41	5.4	4.5
8	4.6	23	7.2	6.0
10	5.8	15	9.0	7.5
12	6.9	10	10.8	9.0

30° Horizontal Aiming

Distance		F.C.	Beam	
D	C		L	W
2	3.5	72	7.6	2.6
3	5.2	32	11.4	3.9
4	6.9	18	15.2	5.2
5	8.7	11	19.0	6.5

LLAVRM Alcyon LED Vertical

Recessed Multiples

Aiming angles

L and W are the outer points where the candle power drops to 50% of the maximum. FC are the initial footcandles at the center of the beam. Data shown is for 3000K, for 2700K multiply FC by 0.91.

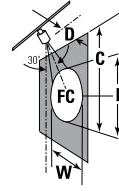
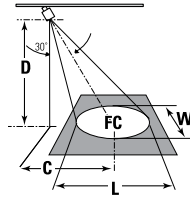

- L Beam length
- D Distance
- W Beam Width
- A Aiming Angle
- FC Footcandles
- C Distance to center beam
- CBCP Center Beam Candlepower.

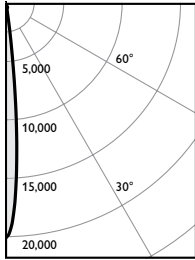

Frame: LLAVRM11H120
Fixture: LLAVRMBK1130H1
Reflector: LLAV11RNS

CCT¹: 3000K
 Output lumens: 1310 lms
 Input watts²: 14.8W
 Efficacy: 88.5lm/w
 CRI: 80 min
 CBCP.: 20,131cd
 Beam Angle: 11°
 Field Angle: 21°
 Report no³: I146GFR

Narrow Spot 30° Horizontal Aiming

Distance		F.C.	Beam	
D	C		L	W
6	3.5	363	1.5	1.3
8	4.6	204	2.1	1.8
10	5.8	131	2.6	2.2
12	6.9	91	3.1	2.7

30° Horizontal Aiming

Distance		F.C.	Beam	
D	C		L	W
2	3.5	629	1.6	0.8
3	5.2	280	2.4	1.2
4	6.9	157	3.2	1.5
5	8.7	101	4.0	1.9

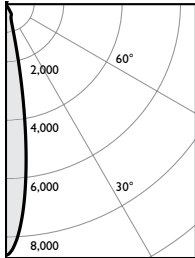

Frame: LLAVRM11H120
Fixture: LLAVRMBK1130H1
Reflector: LLAV11RS

CCT¹: 3000K
 Output lumens: 1320 lms
 Input watts²: 14.8W
 Efficacy: 89.2lm/w
 CRI: 80 min
 CBCP.: 8,637cd
 Beam Angle: 19°
 Field Angle: 35°
 Report no³: I145GFR

Spot 30° Horizontal Aiming

Distance		F.C.	Beam	
D	C		L	W
6	3.5	156	2.7	2.3
8	4.6	88	3.6	3.1
10	5.8	56	4.5	3.9
12	6.9	39	5.4	4.6

30° Horizontal Aiming

Distance		F.C.	Beam	
D	C		L	W
2	3.5	270	2.9	1.3
3	5.2	120	4.4	2.0
4	6.9	67	5.8	2.7
5	8.7	43	7.3	3.3

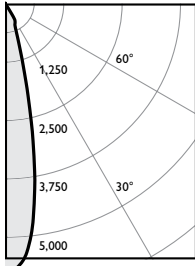

Frame: LLAVRM11H120
Fixture: LLAVRMBK1130H1
Reflector: LLAV11RNF

CCT¹: 3000K
 Output lumens: 1313 lms
 Input watts²: 14.8W
 Efficacy: 88.7lm/w
 CRI: 80 min
 CBCP.: 5,712cd
 Beam Angle: 24°
 Field Angle: 47°
 Report no³: I144GFR

Narrow Flood 30° Horizontal Aiming

Distance		F.C.	Beam	
D	C		L	W
6	3.5	103	3.5	2.9
8	4.6	58	4.6	3.9
10	5.8	37	5.8	4.9
12	6.9	26	6.9	5.9

30° Horizontal Aiming

Distance		F.C.	Beam	
D	C		L	W
2	3.5	179	3.9	1.7
3	5.2	79	5.9	2.6
4	6.9	45	7.9	3.4
5	8.7	29	9.8	4.3

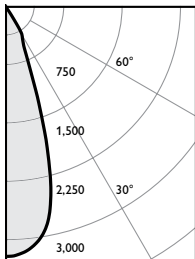

Frame: LLAVRM11H120
Fixture: LLAVRMBK1130H1
Reflector: LLAV11RF

CCT¹: 3000K
 Output lumens: 1298 lms
 Input watts²: 14.8W
 Efficacy: 87.7lm/w
 CRI: 80 min
 CBCP.: 3,209cd
 Beam Angle: 36°
 Field Angle: 63°
 Report no³: I143GFR

Flood 30° Horizontal Aiming

Distance		F.C.	Beam	
D	C		L	W
6	3.5	58	5.4	4.5
8	4.6	33	7.2	6.0
10	5.8	21	9.0	7.5
12	6.9	14	10.8	9.0

30° Horizontal Aiming

Distance		F.C.	Beam	
D	C		L	W
2	3.5	100	7.6	2.6
3	5.2	45	11.4	3.9
4	6.9	25	15.2	5.2
5	8.7	16	19.0	6.5

LLAVRM Alcyon LED Vertical

Recessed Multiples

Aiming angles

L and W are the outer points where the candle power drops to 50% of the maximum. FC are the initial footcandles at the center of the beam. Data shown is for 3000K, for 2700K multiply FC by 0.91.

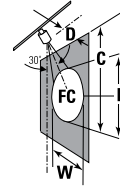
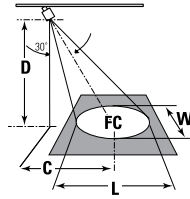

- L Beam length
- D Distance
- W Beam Width
- A Aiming Angle
- FC Footcandles
- C Distance to center beam
- CBCP Center Beam Candlepower.



Frame: –
Fixture: LLAVRMBK12830H1
Reflector: LLAV12RNS

CCT¹: 3000K
 Output lumens: 2247 lms
 Input watts²: 21.4W
 Efficacy: 105.0 lm/w
 CRI: 80 min
 CBCP: 31,716 cd
 Beam Angle: 11°
 Report no³: 1221GFR

Narrow Spot 30° Horizontal Aiming

Distance		F.C.	Beam	
D	C		L	W
6	3.5	572	1.5	1.3
8	4.6	322	2.1	1.8
10	5.8	206	2.6	2.2
12	6.9	143	3.1	2.7

30° Vertical Aiming

Distance		F.C.	Beam	
D	C		L	W
2	3.5	991	1.6	0.8
3	5.2	441	2.4	1.2
4	6.9	248	3.2	1.5
5	8.7	159	4.0	1.9

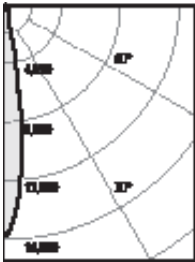

Frame: –
Fixture: LLAVRMBK12830H1
Reflector: LLAV12RS

CCT¹: 3000K
 Output lumens: 2241 lms
 Input watts²: 21.3W
 Efficacy: 105.2 lm/w
 CRI: 80 min
 CBCP: 15,592 cd
 Beam Angle: 18°
 Report no³: 1220GFR

Spot 30° Horizontal Aiming

Distance		F.C.	Beam	
D	C		L	W
6	3.5	281	2.6	2.2
8	4.6	158	3.4	2.9
10	5.8	101	4.3	3.7
12	6.9	70	5.1	4.4

30° Vertical Aiming

Distance		F.C.	Beam	
D	C		L	W
2	3.5	487	2.7	1.3
3	5.2	217	4.1	1.9
4	6.9	122	5.5	2.5
5	8.7	78	6.9	3.2

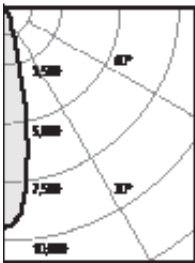

Frame: –
Fixture: LLAVRMBK12830H1
Reflector: LLAV12RNF

CCT¹: 3000K
 Output lumens: 2245 lms
 Input watts²: 21.4W
 Efficacy: 104.9 lm/w
 CRI: 80 min
 CBCP: 9,403 cd
 Beam Angle: 24°
 Report no³: 1219GFR

Narrow Flood 30° Horizontal Aiming

Distance		F.C.	Beam	
D	C		L	W
6	3.5	170	3.5	2.9
8	4.6	95	4.6	3.9
10	5.8	61	5.8	4.9
12	6.9	42	6.9	5.9

30° Vertical Aiming

Distance		F.C.	Beam	
D	C		L	W
2	3.5	294	3.9	1.7
3	5.2	131	5.9	2.6
4	6.9	73	7.9	3.4
5	8.7	47	9.8	4.3

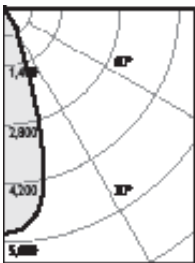

Frame: –
Fixture: LLAVRMBK12830H1
Reflector: LLAV12RF

CCT¹: 3000K
 Output lumens: 2220 lms
 Input watts²: 21.3W
 Efficacy: 104.2 lm/w
 CRI: 80 min
 CBCP: 5,368 cd
 Beam Angle: 36°
 Report no³: 1218GFR

Flood 30° Horizontal Aiming

Distance		F.C.	Beam	
D	C		L	W
6	3.5	97	5.4	4.5
8	4.6	54	7.2	6.0
10	5.8	35	9.0	7.5
12	6.9	24	10.8	9.0

30° Vertical Aiming

Distance		F.C.	Beam	
D	C		L	W
2	3.5	168	7.6	2.6
3	5.2	75	11.4	3.9
4	6.9	42	15.2	5.2
5	8.7	27	19.0	6.5

