

THIS COPY IS PROVIDED ON A RESTRICTED BASIS AND IS NOT TO BE USED IN ANY WAY DETRIMENTAL TO THE INTERESTS OF PANDUIT CORP.

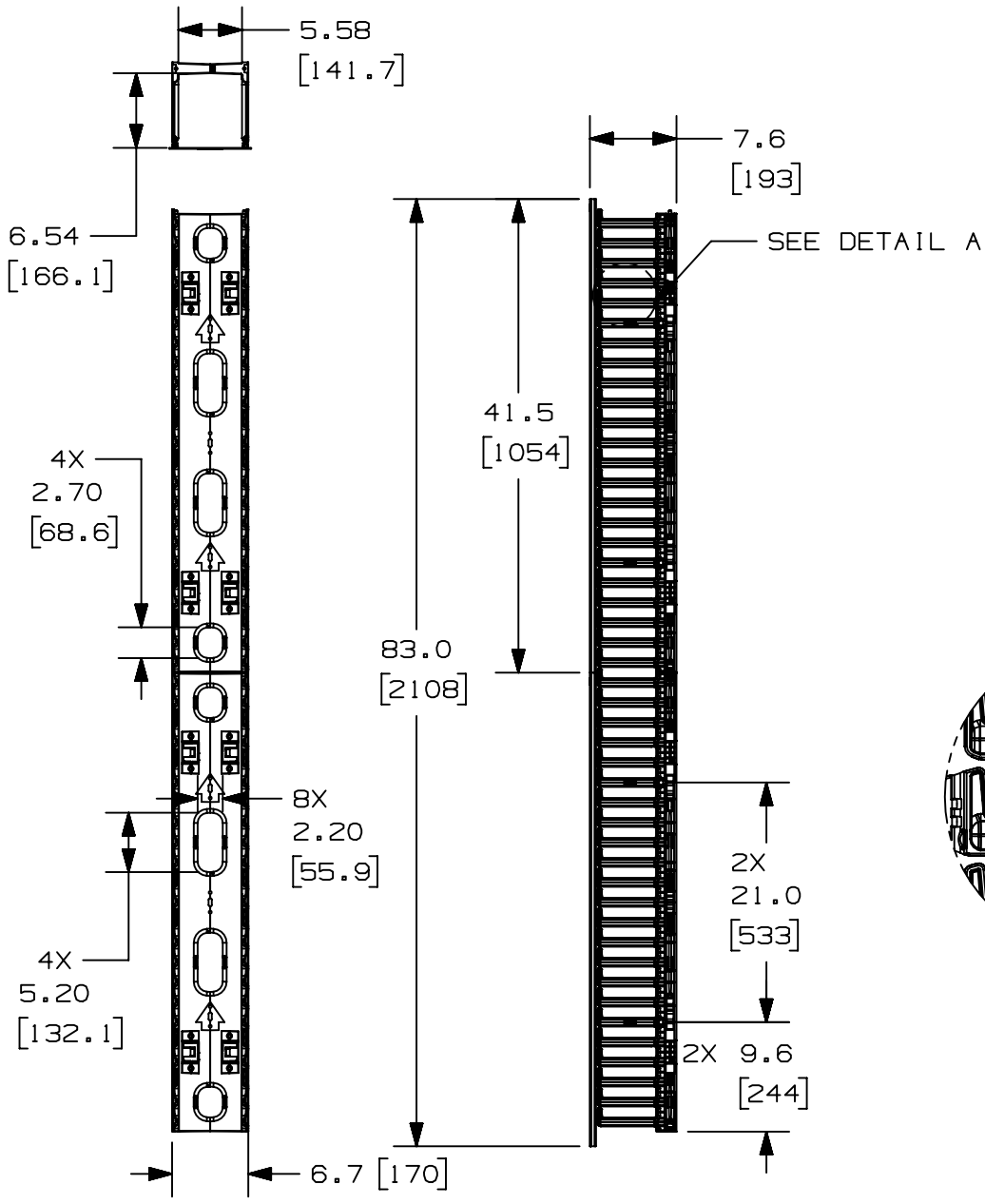

PANDUIT P/N	WEIGHT
WMPVHCF45E	18.0 lbs/EACH 8.16 kg/EACH

- NOTES:
- VISIT OUR ON-LINE CATALOG AT WWW.PANDUIT.COM FOR A CURRENT LIST OF PRODUCTS APPLICABLE FOR USE WITH THIS PART.
 - COMPONENTS:
2- 22.5RU CABLE MANAGEMENT SECTIONS
2- 41.5" DUAL HINGE COVERS
4- MOUNTING BRACKETS
8- #12-24 X 1/2" SCREWS
 - DIMENSIONS IN PARENTHESES ARE METRIC.

MAX STORAGE TEMPERATURE 65° C (149° F)
MAX OPERATING TEMPERATURE 60° C (140° F)

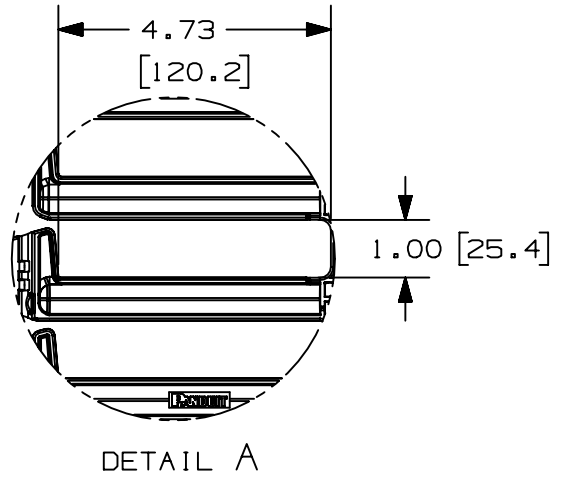

TITLE 6" WIDE FRONT ONLY VERTICAL CABLE MANAGER WMPVHCF45E CUSTOMER DRAWING												
ITEM REVISION NAME V10225AH/08												
DATASET FILE NAME V10225AH_DC/08A												
THIRD ANGLE PROJECTION												
MATERIAL CABLE MANAGER- ABS COVER- PVC				DRAWING NUMBER 10225-26								
REV	DATE	BY	CHK	APR	DESCRIPTION	ECN	DRAWN BY JDWE	DATE 3-15-05	CHK TCK	SCALE NONE	SHEET 1 OF 2	SIZE A

A-SIZE CUSTOMER

THIS COPY IS PROVIDED ON A RESTRICTED BASIS AND IS NOT TO BE USED IN ANY WAY DETRIMENTAL TO THE INTERESTS OF PANDUIT CORP.

2

1

B

A

B

A

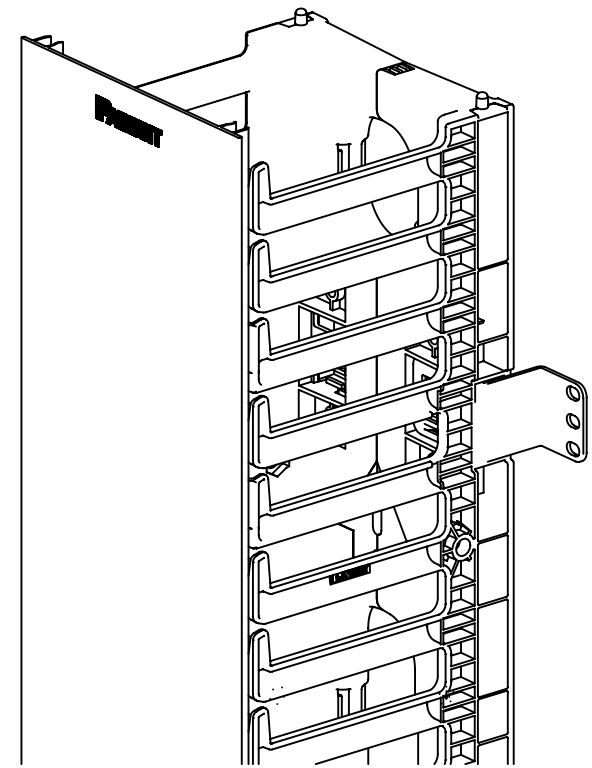
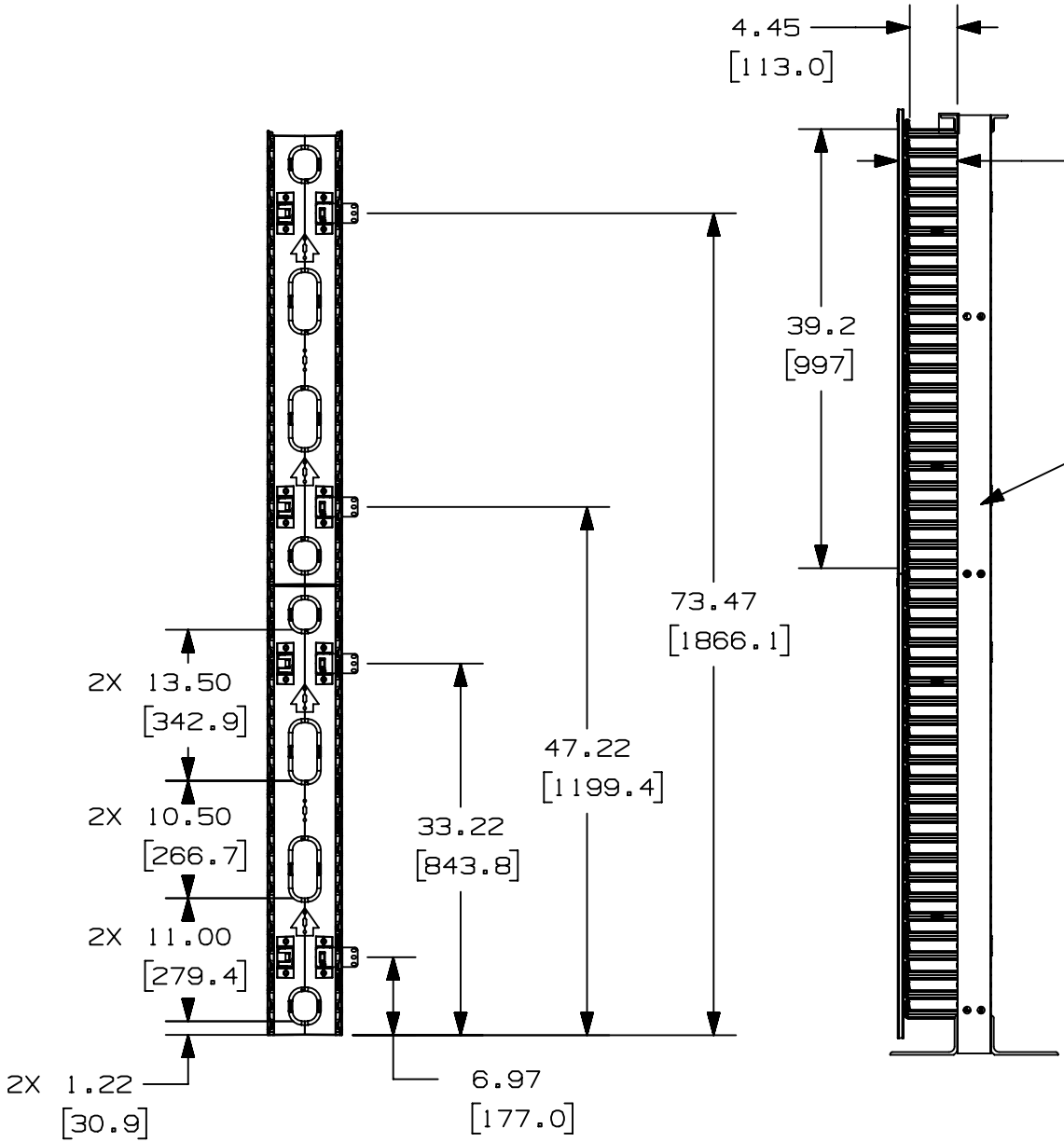

TITLE 6" WIDE FRONT ONLY VERTICAL CABLE MANAGER WMPVHCF45E										
CUSTOMER DRAWING										
ITEM REVISION NAME V10225AH/08					PANDUIT					
DATASET FILE NAME V10225AH_DC/08A										
MATERIAL CABLE MANAGER- ABS COVER- PVC					DRAWING NUMBER 10225-26					
DRAWN BY JDWE					DATE 3-15-05		CHK TCK		SCALE NONE	
REV					DATE		BY		CHK	
APR					DESCRIPTION		ECN		SHEET 2 OF 2	
REFER TO SHEET 1 FOR REVISION CONTROL					---		---		A	

A-SIZE CUSTOMER

2

1