



control wire tap for flat busbar connection accessory for: 3VA53/54; 3VA63/64

Model	
product brand name	SETRON
accessories	Control wire tap
General technical data	
type of electrical connection / with control wire tap	Yes
Connections according IEC	
tightening torque / when using copper cables	
<ul style="list-style-type: none"> <li>• solid</li> </ul>	0.75 - 2.5 mm <sup>2</sup> : 2 Nm
<ul style="list-style-type: none"> <li>• finely stranded</li> </ul>	0.75 - 2.5 mm <sup>2</sup> : 2 Nm
Connections according UL	
permissible temperature / of connectable conductor / according to UL 486A-486B	75 °C
connectable conductor cross-section	
<ul style="list-style-type: none"> <li>• for copper cable / solid / maximum</li> </ul>	14 AWG
<ul style="list-style-type: none"> <li>• for copper cable / stranded / maximum</li> </ul>	14 AWG

Certificates	
General Product Approval	EMV



[Miscellaneous](#)



Marine / Shipping	other	Environment			
<p>LRS</p>	<a href="#">Miscellaneous</a>	<a href="#">Confirmation</a>	<a href="#">Miscellaneous</a>	<a href="#">Environmental Con- firmations</a>	<a href="#">Environmental Con- firmations</a>

### Further information

Information on the packaging  
<https://support.industry.siemens.com/cs/ww/en/view/109813875>  
 Information- and Downloadcenter (Catalogs, Brochures,...)  
<http://www.siemens.com/lowvoltage/catalogs>  
 Industry Mall (Online ordering system)  
<https://mall.industry.siemens.com/mall/en/en/Catalog/product?mlfb=3VA9470-0WC00>  
 Service&Support (Manuals, Certificates, Characteristics, FAQs,...)  
<https://support.industry.siemens.com/cs/ww/en/ps/3VA9470-0WC00>  
 Image database (product images, 2D dimension drawings, 3D models, device circuit diagrams, ...)  
[http://www.automation.siemens.com/bilddb/cax\\_en.aspx?mlfb=3VA9470-0WC00](http://www.automation.siemens.com/bilddb/cax_en.aspx?mlfb=3VA9470-0WC00)  
 CAx-Online-Generator  
<http://www.siemens.com/cax>

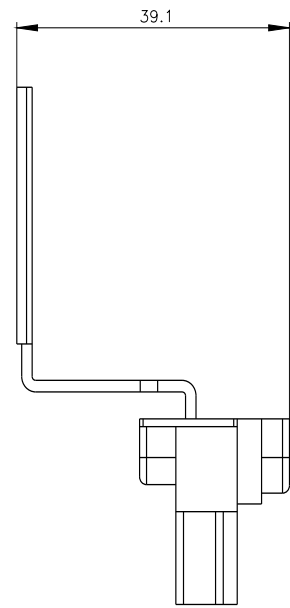
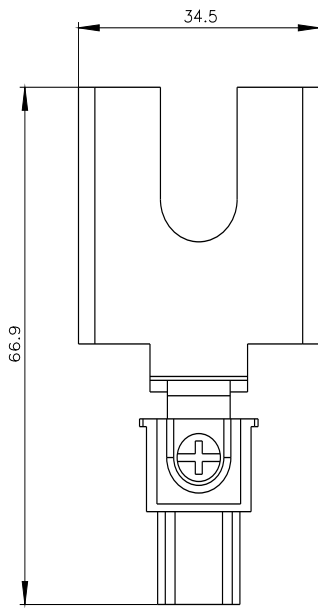

---

last modified:

5/1/2024 

