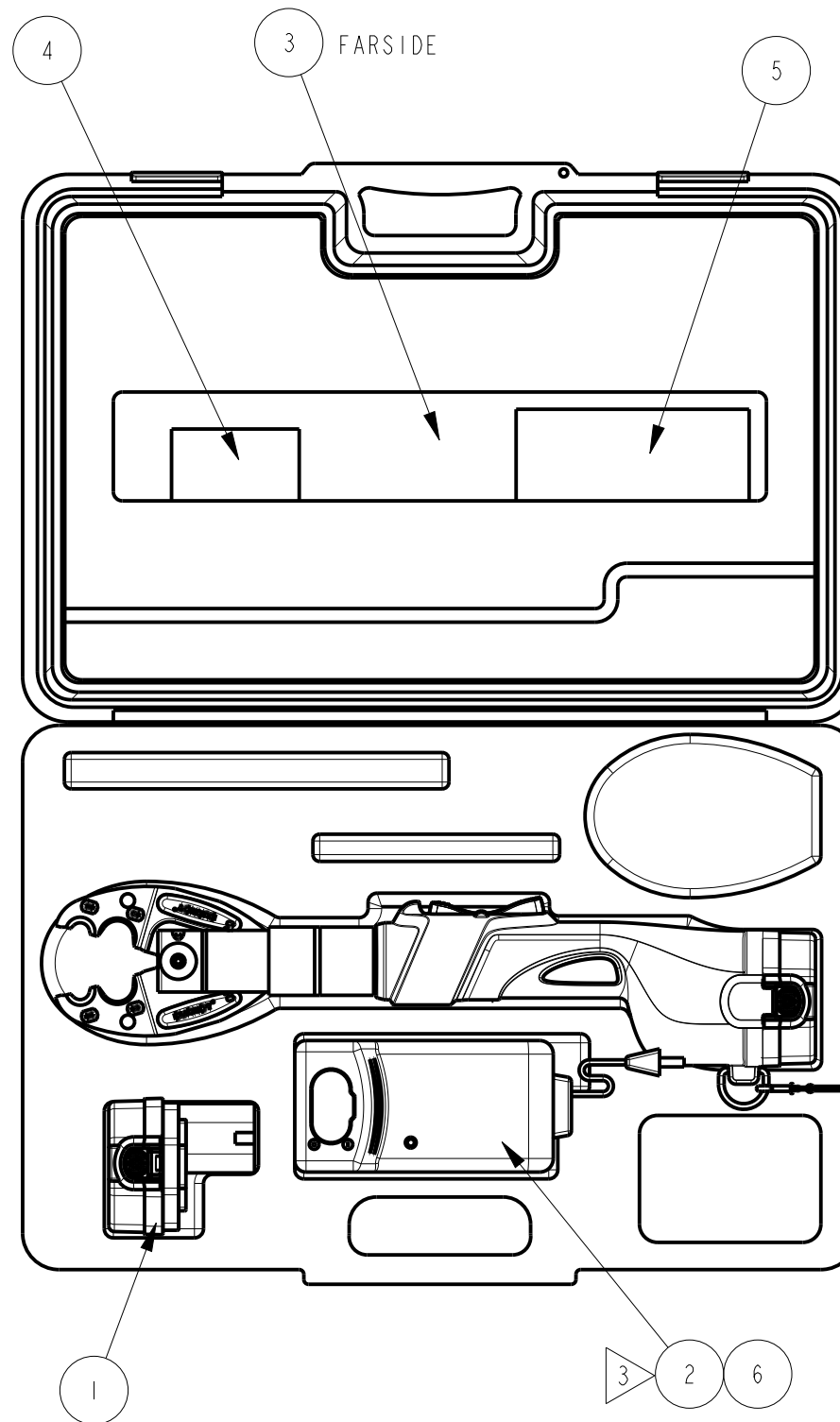

TABLE		
ITEM #	CATALOG #	DESCRIPTION
10072172	PATMD614V	PATMD6 WITH "D3" & "BG" GROOVES 120V CHARGER
10072173	PATMD6814V	PATMD6 WITH "D3" & "O" GROOVES 120V CHARGER
10072174	PATMD6614V	PATMD6 WITH "D3" GROOVE ONLY 120V CHARGER
10072178	PATMD614VDC	PATMD6 WITH "D3" & "BG" GROOVES 12V CHARGER
10072175	PATMD614V250V	PATMD6 WITH "D3" & "BG" GROOVES 250V CHARGER
10072179	PATMD6814VDC	PATMD6 WITH "D3" & "O" GROOVES 12V CHARGER
10072176	PATMD6814V250V	PATMD6 WITH "D3" & "O" GROOVES 250V CHARGER
10072180	PATMD6614VDC	PATMD6 WITH "D3" GROOVE ONLY 12V CHARGER
10072177	PATMD6614V250V	PATMD6 WITH "D3" GROOVE ONLY 250V CHARGER
10088262	PATMD6K14V	PATMD6 WITH KEARNEY JAW 120V CHARGER
10088264	PATMD6K14VDC	PATMD6 WITH KEARNEY JAW 12V CHARGER

REV.	DATE	DESCRIPTION	ECO	BY	C'H'K.
C	02/19/2016 00:00:00 AM	DRAWING RELEASED	40728	TRF	MAC



PATRIOT®

SPECIFICATIONS  
 IN-LINE BATTERY TOOL  
 PATMD6-14V AND PATMD6-814V  
 USES BURNDY "W" DIES  
 CRIMP FORCE: 6 TONS (5.4 METRIC TONS)  
 TOOL WEIGHT: 7.8 LBS (3.53 kg)  
 LENGTH: 20.9 IN (530.8 mm)  
 WIDTH: 3.7 IN (93.7 mm)  
 HEIGHT: 5.5 IN (141.7 mm)  
 OPERATING VOLTAGE: 14.4 V-DC  
 RECHARGE TIME: < 45 MINUTES

SPECIFICATIONS  
 IN-LINE BATTERY TOOL  
 PATMD6-6-14V  
 USES BURNDY "W" DIES  
 CRIMP FORCE: 6 TONS (5.4 METRIC TONS)  
 TOOL WEIGHT: 7.6 LBS (3.44 kg)  
 LENGTH: 20 IN (508 mm)  
 WIDTH: 3.7 IN (93.7 mm)  
 HEIGHT: 5.5 IN (141.7 mm)  
 OPERATING VOLTAGE: 14.4 V-DC  
 RECHARGE TIME: < 45 MINUTES

SPECIFICATIONS  
 IN-LINE BATTERY TOOL  
 PATMD6K-14V  
 USES KEARNEY DIES & BURNDY "W" DIES  
 WITH KWADP ADAPTERS  
 CRIMP FORCE: 6 TONS (5.4 METRIC TONS)  
 TOOL WEIGHT: 7.6 LBS (3.44 kg)  
 LENGTH: 20.6 IN (523.2 mm)  
 WIDTH: 3.7 IN (93.7 mm)  
 HEIGHT: 5.5 IN (141.7 mm)  
 OPERATING VOLTAGE: 14.4 V-DC  
 RECHARGE TIME: < 45 MINUTES

\*\*\* BILL OF MATERIAL \*\*\*

PT NO.	CATALOG NO.	QTY	DESCRIPTION
1	BAT14V	2	BATTERY, 14.4 VOLT Ni-MH
2	PATCHGR18V	1	120 V-AC CHARGER
2	BCT/PATDCCHGR	1	12V-DC CHARGER
2	PATCHGR250V	1	250V-AC CHARGER
3	PT10059993	1	LABEL, TOOL CASE (PAT750XT-18V)
4	PT20443801	1	WARRANTY CARD
5	PATMD6OM1	1	SOM1, PATMD6-14.4V
6	BATCHGR-18VSOM1	1	BATTERY CHARGER SAFETY OPERATING & MAINT. INST.

FEATURES

- TRUE ONE HANDED OPERATION FOR ADVANCE, RETRACT AND HOLD.
- 6 TON OUTPUT FORCE.
- STATE OF THE ART CRIMPING HEAD DESIGN, 350° ROTATION.
- AUDIBLE "POP OFF" INDICATES PROPERLY COMPLETED CRIMPS.
- ERGONOMICALLY BALANCED TOOL.
- DURABLE HIGH IMPACT CARRYING CASE.
- 3 YEAR LIMITED WARRANTY ON THE TOOL.
- 1 YEAR WARRANTY ON THE BATTERY.
- Ni-MH BATTERY ELIMINATES VOLTAGE DEPRESSION (MEMORY ISSUES).

BENEFITS

- VERSATILE TOOL HEAD POSITIONING LETS USER GET INTO TIGHT AREAS.
- LESS DOWN TIME DUE TO HIGH CAPACITY, HIGH VOLTAGE 14.4 VOLT BATTERY.
- ASSURES PROPER CRIMPS WITH AUDIBLE INDICATOR, LEAVING NO DOUBT FOR TOOL USER.
- ERGONOMICALLY BALANCED TOOL.
- SMOOTHER, QUIETER, MORE EFFICIENT TOOL OPERATION.

NOTES:

- ALL PATRIOT PRODUCTS ARE AVAILABLE WITH A DC CHARGER PERMITTING THE CHARGING OF 18V DC BATTERIES WITH A 12V SYSTEM.
- TO ORDER 12 VOLT DC CHARGER SEPARATELY, ORDER CATALOG NUMBER BCT/PATDCCHGR. THIS CHARGER ACCOMODATES BATTERIES FROM 12V - 18V.
- EACH TOOL INCLUDES ONE CHARGER, WHICH IS DETERMINED BY THE TOOL CATALOG NUMBER.

TO ORDER BURNDY® PRODUCTS CALL  
 UNITED STATES:  
 1-800-346-4175 (LONDONDERRY, NH)  
 CANADA:  
 1-800-361-6975 (QUEBEC)  
 1-800-387-6487 (ALL OTHER PROVINCES)  
 FOR PRODUCT INFO: <http://www.burndy.com>

PATMD6	
ITEM NO: SEE TABLE	
CAT. NO: SEE TABLE	
DRAWN BY: T. FAUCHER 01/21/2009	
CHECKER: M. CHIASSON 01/21/2009	
DSN APPVL: M. CHIASSON 01/22/2009	
MFG APPVL: --	
QA APPVL: J. AYER 01/26/2009	
MKT APPVL: R. POIRIER 01/22/2009	
PROD FAM: TOOLS, BATTERY	SCALE: 1:4
PROJECT #: 13204	DRAWING NO
DOCUMENT TYPE: Sales	10072190
REL LEVEL: Released	SHEET 1 OF 2

REV: PE0200

REV.	DATE	DESCRIPTION	ECO	BY	C'H'K.
C	02/19/2016 00:00:00 AM	DRAWING RELEASED	40728	TRF	MAC

**PATRIOT®**  
**PATMD6-14V AVAILABLE JAW SETS**

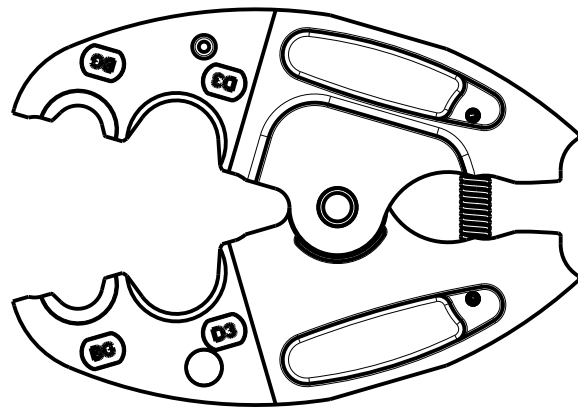

CATALOG # PATJAWSMD6  
 JAWS CONTAIN "D3" & "BG" GROOVES

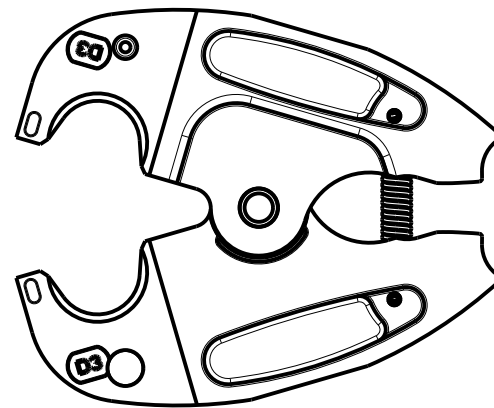

CATALOG # PATJAWMD6-6  
 JAWS CONTAIN "D3" GROOVE (SNUB NOSE)

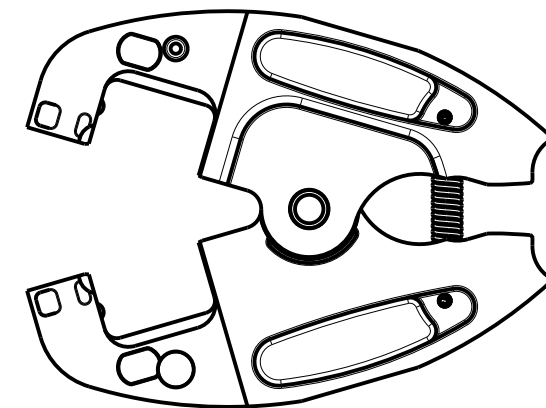

CATALOG # PATJAWMD6K  
 JAWS CONTAIN KEARNEY GROOVE

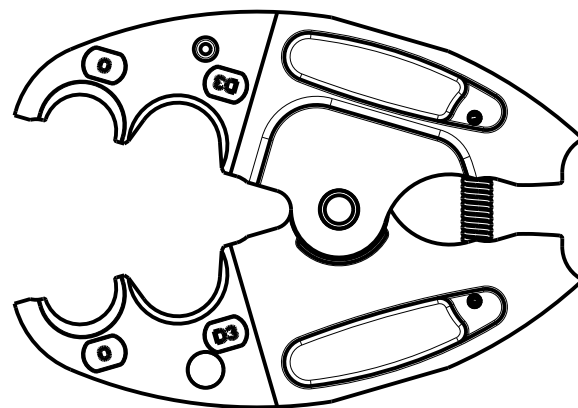

CATALOG # PATJAWSMD6-8  
 JAWS CONTAIN "D3" & "O" GROOVES

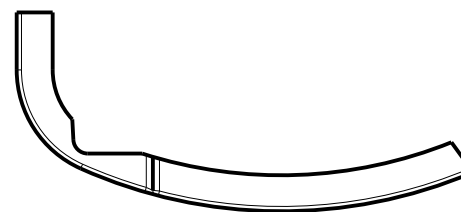

CATALOG # PATMD66JC  
 RUBBER COVER FITS (PATJAWSMD6-6)

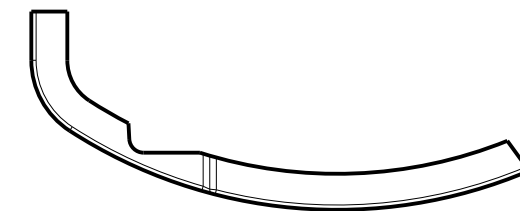

CATALOG # PATMD6KJC  
 RUBBER COVER FITS (PATJAWSMD6K)

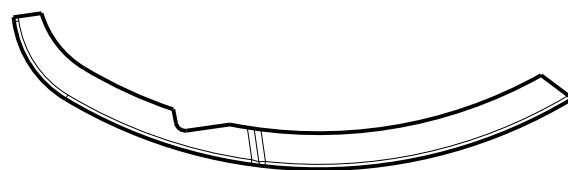

CATALOG # PATMD6JC  
 RUBBER COVER FITS (PATJAWSMD6 & PATJAWSMD68)

TO ORDER BURNDY® PRODUCTS CALL		PATMD6	
UNITED STATES:		ITEM NO: SEE TABLE SHEET I	
1-800-346-4175 (LONDONDERRY, NH)		CAT. NO: SEE TABLE SHEET I	
CANADA:		DRAWN BY: T. FAUCHER 01/21/2009	
1-800-361-6975 (QUEBEC)		CHECKER: M. CHIASSON 01/21/2009	
1-800-387-6487 (ALL OTHER PROVINCES)		DSN APPVL: M. CHIASSON 01/22/2009	
FOR PRODUCT INFO: <a href="http://www.burndy.com">http://www.burndy.com</a>		MFG APPVL: --	
		QA APPVL: J. AYER 01/26/2009	
		MKT APPVL: R. POIRIER 01/22/2009	
		SCALE: 1:4	
		DRAWING NO	
		10072190	
		REV	
		C	
		SHEET 2 OF 2	

REV: PE0200