

NEW!
More on
reverse

Zinc Intersystem Grounding Bridge

Threaded for Pipe • Set screw for EMT, PVC • Meets NEC



Installs on the Conduit of Your Choice!



GB5T with **Threaded Pipe**



Installing **EMT** using set screw



PVC pipe works with GB5T

...Using One or Two GB5T ground bridges for the installation of five or more intersystem bonding jumpers

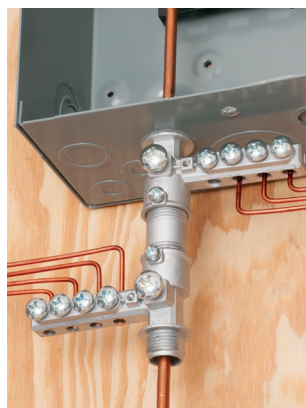

Arlington's new heavy-duty **GB5T** zinc Grounding Bridge provides reliable intersystem bonding between power and communication grounding systems.

And convenient, time-saving installation options! It's threaded for use on threaded conduit *or another GB5T*, but also has a set screw for use on EMT or PVC.

A locknut holds it securely in an electrical panel box.

Four termination points, more than required by 250.94(A)(2) of the NEC, handle multiple hookups of communications systems – telephone, CATV or satellite dish. *Multiple GB5Ts may be ganged together where five or more Intersystem Bonding Jumpers are needed.*

- For indoor or outdoor use (UV rated)
- **Intersystem Bonding and Grounding Conductors:**
#14 - 4 AWG
- **Grounding Electrode Conductor or Equipment Grounding Conductor:**
#6 - #2 AWG
- Fast, simple installation
- Easy access for inspections
- For added good looks add the textured, paintable plastic cover



Patent pending



Arlington®

1 Stauffer Industrial Park
Scranton, PA 18517
800/233.4717 • Fax 570/562.0646
www.aifittings.com



Zinc Intersystem Grounding Bridge

Convenient, Time-saving • Threaded for Pipe • Set screw for EMT, PVC

Fast, Easy Installation

Single GB5T into Electrical Panel

- 1 Remove locknut from GB5T. Insert into electrical panel box. Replace locknut.
- 2 Install grounding electrode conductor (GEC) through ground bridge. Connect to ground bus in panel. Tighten lug screw to secure.
- 3 Install conduit. For EMT (shown) tighten set screw. GB5T is also threaded for pipe or threaded male adapter for PVC conduit.
- 4 Connect intersystem bonding jumpers to GB5T.
- 5 Add paintable textured cover.



Connect GB5Ts for the installation of five or more Intersystem Bonding Jumpers

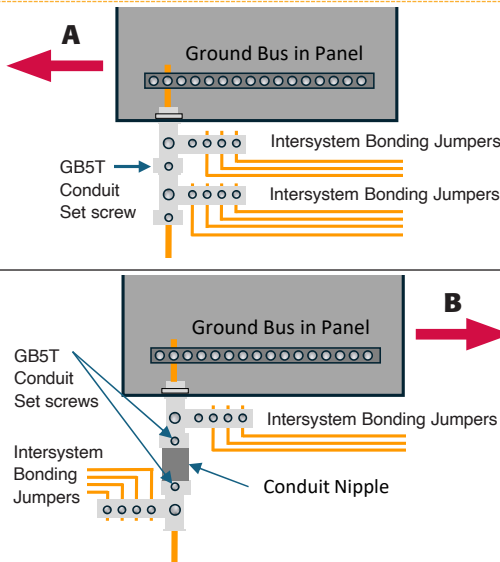
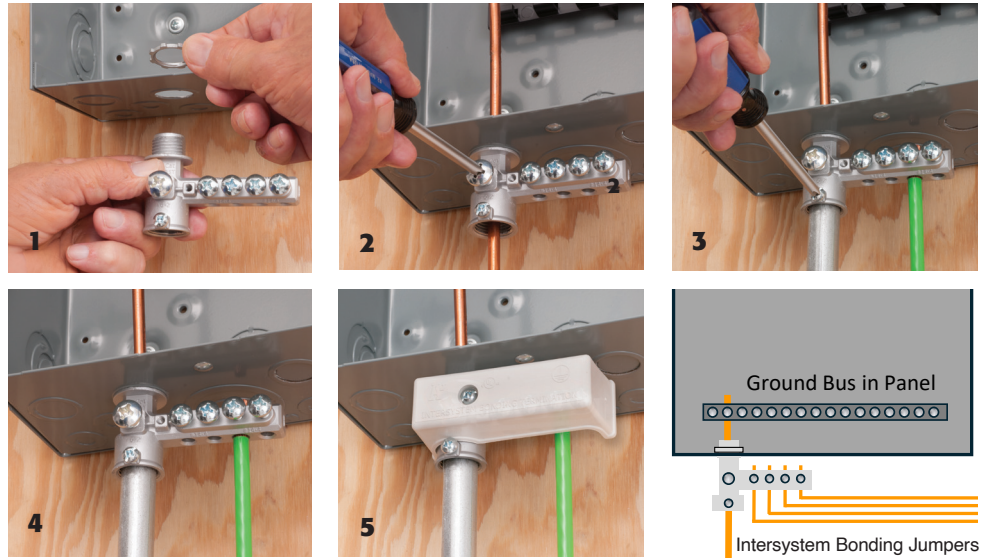

GB5Ts Interconnected – facing the same direction (A)

- 1 Remove locknut from both GB5T ground bridges.
- 2 Thread one GB5T into the other until tight. Unscrew slightly to align GB5Ts together on same side.
- 3 Tighten conduit set screw on the UPPER GB5T to securely connect the two. Install in panel KO. Secure with locknut.
- 4 Install grounding electrode conductor (GEC) through BOTH ground bridges. Connect to ground bus in panel. Tighten lug screws in BOTH GB5Ts.
- 5 Connect intersystem bonding jumpers to both GB5Ts.

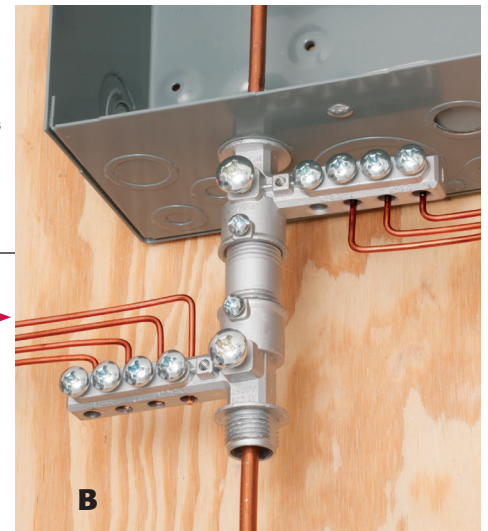

GB5Ts connected in opposing directions (B)

- 1 Remove locknut from both GB5T ground bridges.
- 2 Install conduit nipple BETWEEN GB5Ts. Conduit nipple can be 1/2" EMT or threaded IMC or RMC.
- 3 Tighten conduit set screws on BOTH GB5Ts to securely connect the two. Install in panel KO. Secure with locknut.
- 4 Install grounding electrode conductor (GEC) through BOTH ground bridges. Connect to ground bus in panel. Tighten lug screws in BOTH GB5Ts.
- 5 Connect intersystem bonding jumpers to both GB5Ts.



Arlington[®]

1 Stauffer Industrial Park
Scranton, PA 18517
800/233.4717 • Fax 570/562.0646
www.aifittings.com

Catalog Number	UPC/DEI/NAED Mfg. #018997	Description	Unit Pkg	Std Pkg
GB5T	99320	Heavy-duty zinc, Threaded for pipe With set screw for EMT, PVC	1	10

Distributed by

Patent pending

GB5T 0624/25M