

the radiant[®] *collection*

Smart LED Dimmer,
Matter-Enabled with Wi-Fi



 **legrand[®]**

before you start

Review this guide in its entirety. Consult an electrician with any questions or if you are unsure of your abilities.



Warning: Incorrect installation could result in death, serious injury, and/or damage to your home or devices.

Caution: To reduce the risk of injury and/or overheating and damage to other equipment:

- For dry, indoor use only.
- Do not use to power medical equipment.
- Not suitable as a disconnecting means.
- Do not use with loads exceeding the device load rating.
- Connect the smart dimmer to a 120 VAC, 60 Hz power source ONLY.
- Install on circuit protected by 20A branch circuit overcurrent protection.
- Always use copper wire (#14 - 12AWG) to install the smart outlet and follow all applicable local and national electrical codes.
- Do not install to control a receptacle, a motor-operated appliance, a fluorescent lighting fixture, or a transformer-supplied appliance.
- For control of incandescent or LED luminaires only.

what you need

REQUIRED:

-  Phillips-head screwdriver
-  Flat blade screwdriver

YOU MAY ALSO NEED:

Voltage tester, pliers, wire cutter, wire stripper, electrical tape, flashlight, and wire nuts

SCAN TO WATCH
THE INSTALLATION
VIDEO



installation & setup

1 | turn off power to device at circuit breaker

Flip existing light switch multiple times to confirm power is off.

NOTE: Ensure power is off to all devices in electrical box.

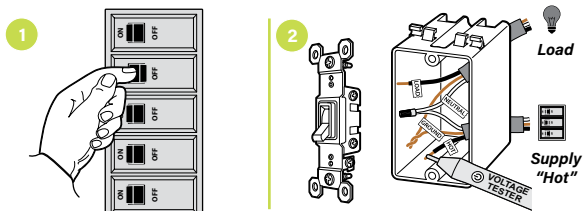

2 | remove existing device

Check for the following wires:

- a** **HOT or LINE:** Receives power from the circuit box. Referred to as “hot” for the purposes of this guide. Do not touch or let “hot” wires contact other wires.
- b** **LOAD:** Directs power to your light(s).
- c** **NEUTRAL:** Creates a path to return current to the power source when the device is off. Required for your dimmer installation.
- d** **GROUND:** Provides a safe path for electricity in the event of a short circuit.
- e** **TRAVELER:** If more than one dimmer controls the light, an additional wire will be in the box that “travels” to the other dimmer. Not used in single dimmer applications. For multiple dimmer applications see 3b.

3a | wire smart dimmer

Use the wire nuts provided to secure the wires together.

- a Connect the WHITE neutral wire on the dimmer to the neutral wires in the box, using the red wire nut.
- b Connect the LOAD wire on the dimmer to the load wire in the box.
- c Connect the HOT wire on the dimmer to the hot wire(s) in the box.
- d Connect the GREEN ground wire on the dimmer to the ground wire(s) in the box.
- e If the light is controlled with only one switch, use a wire nut to cap the YELLOW traveler wire on the device and proceed to step 4.

NOTE: If the light is controlled by two or more switches (3-way), see 3b for instructions

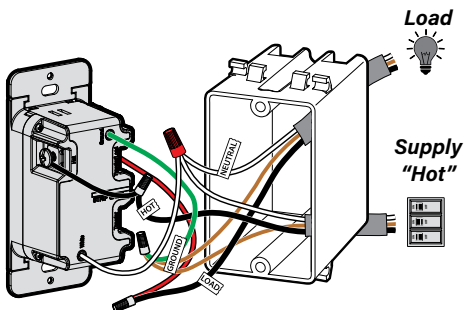

3b (optional) | 3-way wiring with traditional switch

If your switch is a part of a 3-way installation, the dimmer must be installed on the “Line/Hot” side of the circuit. A traditional switch should be used on the load side.

- a Connect the WHITE neutral wire from the switch to the neutral wires in the box
- b Connect the LOAD wire on the dimmer to one of the two traveler wires in the box
- c Connect the HOT wire on the dimmer to the hot wire(s) in the box
- d Connect the GREEN ground wire on the dimmer to the ground wire(s) in the box
- e Connect the TRAVELER wire to the last traveler wire in the box

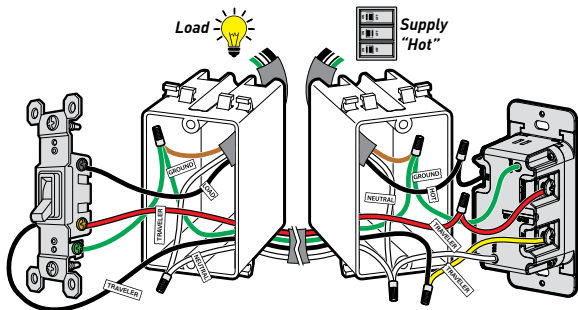

SCAN TO WATCH THE
INSTALLATION VIDEO



4 | secure smart dimmer

- a Fold wires into electrical box, taking care not to pinch a wire.
- b Use included screws to secure smart dimmer to electrical box. Do not fully tighten the screws.

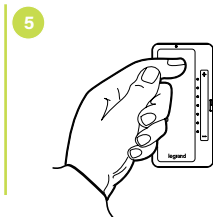
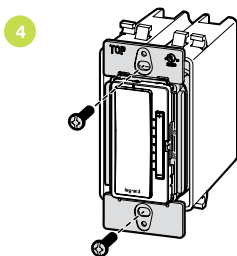

5 | test the smart dimmer

NOTE: See getting to know your dimmer section for feature details.

Turn the power back on at the circuit breaker, press dimmer to turn light on/off and use the dimmer paddle to adjust the level of your light(s).

TROUBLESHOOTING TIP:

If the device is not powering check wiring to determine if you have reversed the "hot" and "load" wiring.

6 | attach wall plate

- A** Use the sub-plate screws (provided) to secure the sub-plate to the smart switch.
- B** Tighten device screws to secure to the electrical box.
- C** Angle the  end of the wall plate over the top edge of the sub-plate. Push the screwless wall plate down and in until it "snaps" into place over the sub-plate.

Note: To remove the wall plate, place the tip of a flat blade screwdriver into the slot under the wall plate and twist gently.

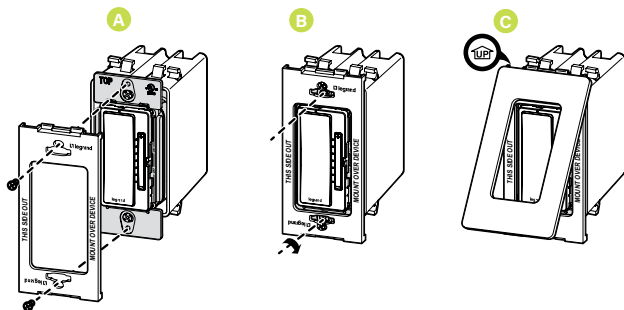

7 | set up your Matter-compatible dimmer

This product is Matter-certified and designed to be used with a Matter-compliant smart home platform (Amazon Alexa, Google Home, Apple Home, Samsung SmartThings, etc.)

- 1 A Matter-compliant controller (Home Hub / Admin) and smart home app of the same platform is required for setup.
- 2 Turn on Bluetooth and connect to a 2.4 GHz Wi-Fi network on your smartphone (5 GHz networks not supported)
- 3 Open your Matter-complaint smart home app and follow the in-app instructions for adding a Matter device.

TROUBLESHOOTING TIP:

If the dimmer is not appearing during setup or fails during the setup process, confirm that the device is powered and perform the factory reset procedure. Once the device has been reset, restart the setup process in your smart home app.

MULTIPLE PLATFORMS:

If wanting to provide access across multiple smart home platforms, the initial QR code on the device will only work with the first app that was used. To setup in subsequent apps and systems, a new Matter code will need to be generated in the original app the device was setup with.



QUICK SETUP TIP:

For an even faster setup process, open the Camera app on your phone and scan the QR code on the back of the device. This will set the plug device up in your preferred Matter-compatible smart home platform.

getting to know your dimmer

Item	Name	Description
1	Paddle Switch	<ul style="list-style-type: none">Press the top of the paddle to turn light on. Double-tap to raise the dimming percentage to 100%.Press the bottom of paddle to turn light off.
2	LED Locator Light	<ul style="list-style-type: none">Indicates the current state of device. Refer to "LED Locator Light Explanations" for detail.
3	Dimmer Paddle / LED Light Level	<ul style="list-style-type: none">Controls and displays the dimming percentage.Press (+/-) to adjust light in 2% increments. Hold (+/-) to adjust light in 20% increments.
4	Air Gap Switch	<ul style="list-style-type: none">Completely turns off the dimmer. Use when changing light bulbs.

LED LOCATOR LIGHT EXPLANATIONS

LED Color	State of Light	Explanation
	Blinking Green	Device is attempting to connect to the network.
	Solid White	Device is connected to your network and is switched off.
	Blinking Green / Red	Device is being reset to factory default.

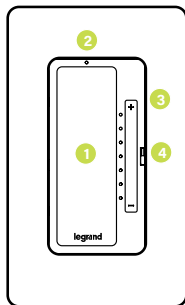

RESET TO FACTORY DEFAULT

To manually reset the dimmer to factory defaults press and hold the dim (-) button for 10 seconds until you see the LED blink then release. The device will reset in about 20 seconds after release.

regulatory information

FCC NOTICE

This device complies with Part 15 of the FCC rules. Operation is subject to the following two conditions: (1) this device may not cause harmful interference, and (2) this device must accept any interference received, including interference that may cause undesirable operation.

This equipment has been tested and found to comply with the limits for a Class B digital device, pursuant to Part 15 of the FCC Rules. These limits are designed to provide reasonable protection against harmful interference in a residential installation. This equipment generates, uses, and can radiate radio frequency energy and, if not installed and used in accordance with the instructions, may cause harmful interference to radio communications. However, there is no guarantee that interference will not occur in a particular installation.

If this equipment does cause harmful interference to radio or television reception, which can be determined by turning the equipment off and on, the user is encouraged to try to correct the interference by one or more of the following measures:

- Reorient or relocate the receiving antenna
- Increase the separation between the equipment and receiver
- Connect the equipment into an outlet on a circuit different from that to which the receiver is connected
- Consult the dealer or an experienced radio/TV technician for help

This equipment complies with FCC radiation exposure limits set forth for an uncontrolled environment. This equipment should be installed and operated with a minimum distance of 20 cm between the transmitter's radiating structure(s) and the body of the user or nearby persons.

Note: Any changes or modifications to this device that are not expressly approved by the manufacturer will void the warranty and the user's authority to operate the equipment.

FCC ID: 2AC7Z-ESPC3MINI1

IC NOTICE

This device complies with Industry Canada license-exempt RSS standards. Operation is subject to the following two conditions: (1) this device may not cause interference; and (2) this device must accept any interference, including interference that may cause undesired operation of the device.

RF EXPOSURE STATEMENT

This equipment meets the SAR evaluation limits given in RSS-102 Issue 5 requirements at the minimum separation distance of 15 mm to the human body.

Note: Any changes or modifications to this device that are not expressly approved by the manufacturer, will void the warranty and the user's authority to operate the equipment.

IC ID: 21098-ESPC3MINI1

ADDITIONAL INFORMATION:

Purpose of Control: Manual Control
Method of Providing Earthing of Control: Ground Terminal
Action Control Type: 1
Disconnection Type: Micro
Pollution Degree: 2
Rated Impulse Voltage: 2500V



Wi-Fi® is a registered trademark of Wi-Fi Alliance®.

warranty

This product is warranty under normal use against deficits in workmanship and materials for one (1) year following your purchase. If the product fails due to a manufacturing defect during normal use, contact the store where purchased or contract technical support at 1-877-833-3303.

A dated sales receipt must be provided for all replacement requests (legible copies are acceptable).

Additional warranty details are available at <http://www.legrand.us> under your device's product page.

specifications

The dimmer is a forward-phase TRIAC-based dimmer intended to be used with dimmable LED, incandescent, and halogen load types

Load	Rating
LED	1.25A, 150W (1 - 3-Gang)
Incandescent/Halogen	300W (1 - 3-Gang)

Legrand reserves the right to change specifications without notice.

customer support:

Please contact our customer support team for assistance.

Available Monday – Friday, 8AM – 6PM ET
(Excluding Holidays)

Phone: (877) 833-3303

E-mail: smartlights@legrand.us



Legrand, North America

50 Boyd Avenue
Syracuse, NY 13209
1-877-833-3303
www.legrand.us