

# *the* radiant<sup>®</sup> *collection*

---

Smart Switch,  
Matter-Enabled with Wi-Fi

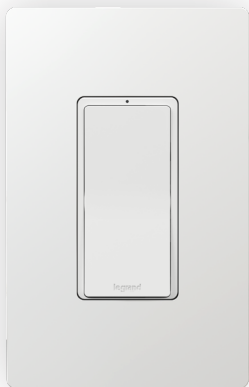

# before you start

Review this guide in its entirety. Consult an electrician with any questions or if you are unsure of your abilities.

**Warning:** Incorrect installation could result in death, serious injury, and/or damage to your home or devices.

**Caution:** To reduce the risk of injury and/or overheating and damage to other equipment:

- For dry, indoor use only.
- Do not use to power medical equipment.
- Do not use with loads exceeding the device load rating.
- Connect the smart switch to a 120 VAC, 60 Hz power source ONLY.
- Not suitable as a disconnecting means.
- Always use copper wire (#14 - 12AWG) to install the smart switch and follow all applicable local and national electrical codes.
- Install on a circuit protected by 20A branch circuit overcurrent protection.

# what you need

## REQUIRED:

⊕ Phillips-head screwdriver

⊖ Flat blade screwdriver

## YOU MAY ALSO NEED:

Voltage tester, pliers, wire cutter, wire stripper, electrical tape, flashlight, and wire nuts

SCAN TO WATCH  
THE INSTALLATION  
VIDEO



# installation & setup

## 1 | turn off power to device at circuit breaker

Flip existing light switch multiple times to confirm power is off.

**NOTE:** Ensure power is off to all devices in electrical box.

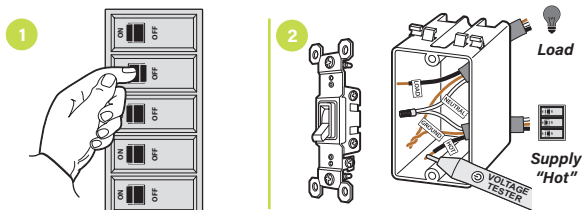

## 2 | remove existing device

Check for the following wires:

- a **HOT or LINE:** Receives power from the circuit box. Referred to as “hot” for the purposes of this guide. Do not touch or let “hot” wires contact other wires.
- b **LOAD:** Directs power to your light(s).
- c **NEUTRAL:** Creates a path to return current to the power source when the device is off. Required for your dimmer installation.
- d **GROUND:** Provides a safe path for electricity in the event of a short circuit.
- e **TRAVELER:** If more than one dimmer controls the light, an additional wire will be in the box that “travels” to the other dimmer. Not used in single dimmer applications. For multiple dimmer applications see 3b.

## 3a | wire smart switch

When connecting each wire, loosen the terminal screws and wrap the wires around the screws.

- a Connect the WHITE neutral wire from the switch to the neutral wires in the box
- b Connect the LOAD wire from the box to the Traveler/Load terminal
- c Connect the HOT wire from the box to the Hot terminal
- d Connect the GREEN ground wire from the switch to the ground wires in the box
- e Tighten all screw terminals to 12 in-lbs (1.4 Nm)

*If the light is controlled by two or more switches (3-way), see 3b for instructions.*

**NOTE:** Copper wire only

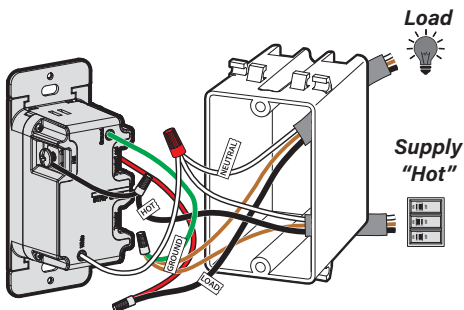

### 3b (optional) | wire 3-way smart switch

If your switch is a part of a 3-way installation, the switch must be installed on the “Line/Hot” side of the circuit. A traditional switch should be used on the load side.

- a Connect the WHITE neutral wire from the switch to the neutral wires in the box
- b Connect the LOAD wire on the switch to one of the two traveler wires in the box
- c Connect the HOT wire on the switch to the hot wire(s) in the box
- d Connect the GREEN ground wire on the switch to the ground wire(s) in the box
- e Connect the TRAVELER wire to the last traveler wire in the box

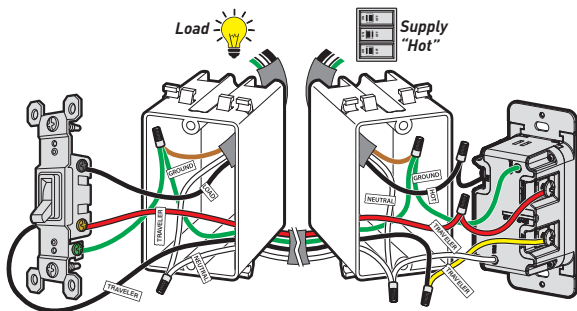

SCAN TO WATCH THE  
INSTALLATION VIDEO



## 4 | secure smart switch

- a Fold wires into electrical box, taking care not to pinch a wire.
- b Use included screws to secure smart switch to electrical box. Do not fully tighten the screws.

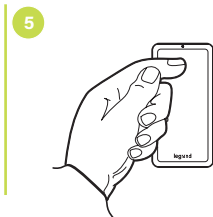
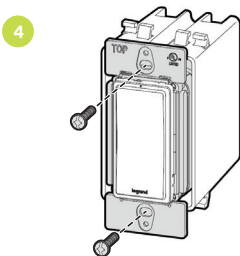

## 5 | test the smart switch

**NOTE:** See getting to know your switch section for feature details.

Turn the power back on at the circuit breaker and press switch to turn light on/off.

### TROUBLESHOOTING TIP:

If the device is not powering check wiring to determine if you have reversed the "hot" and "load" wiring.

## 6 | attach wall plate

- A** Use the sub-plate screws (provided) to secure the sub-plate to the smart switch.
- B** Tighten device screws to secure to the electrical box.
- C** Angle the  end of the wall plate over the top edge of the sub-plate. Push the screwless wall plate down and in until it "snaps" into place over the sub-plate.

**Note:** To remove the wall plate, place the tip of a flat blade screwdriver into the slot under the wall plate and twist gently.

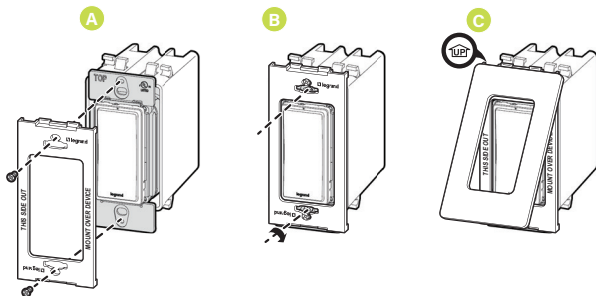

## 7 | set up your Matter-compatible switch

This product is Matter-certified and designed to be used with a Matter-compliant smart home platform (Amazon Alexa, Google Home, Apple Home, Samsung SmartThings, etc.)

- 1 A Matter-compliant controller (Home Hub / Admin) and smart home app of the same platform is required for setup.
- 2 Turn on Bluetooth and connect to a 2.4 GHz Wi-Fi network on your smartphone (5 GHz networks not supported)
- 3 Open your Matter-complaint smart home app and follow the in-app instructions for adding a Matter device.

### **TROUBLESHOOTING TIP:**

If the switch is not appearing during setup or fails during the setup process, confirm that the device is powered and perform the factory reset procedure. Once the device has been reset, restart the setup process in your smart home app.

### **MULTIPLE PLATFORMS:**

If wanting to provide access across multiple smart home platforms, the initial QR code on the device will only work with the first app that was used. To setup in subsequent apps and systems, a new Matter code will need to be generated in the original app the device was setup with.

### **QUICK SETUP TIP:**



For an even faster setup process, open the Camera app on your phone and scan the QR code on the back of the device. This will set the plug device up in your preferred Matter-compatible smart home platform.



# getting to know your switch

Item	Name	Description
1	Paddle Switch	<ul style="list-style-type: none"><li>Press the top of the paddle to turn the light on and the bottom to turn the light off.</li><li>Press the bottom of paddle to turn light off.</li></ul>
2	LED Locator Light	<ul style="list-style-type: none"><li>Indicates the current state of device. Refer to "LED Locator Light Explanations" for detail.</li></ul>

## LED LOCATOR LIGHT EXPLANATIONS

LED Color	State of Light	Explanation
	Blinking Green	Device is ready for setup on your network.
	Solid White	Device is connected to your network and is switched off.
	Blinking Green / Red	Device is being reset to factory default.

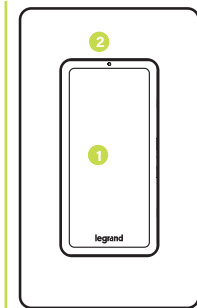

## RESET TO FACTORY DEFAULT

To manually reset the switch to factory defaults press and hold the off button for 10 seconds until you see the LED blink green and red, then release. The device will reset in about 20 seconds after release.

# regulatory information

## FCC NOTICE

This device complies with Part 15 of the FCC rules. Operation is subject to the following two conditions: (1) this device may not cause harmful interference, and (2) this device must accept any interference received, including interference that may cause undesirable operation.

This equipment has been tested and found to comply with the limits for a Class B digital device, pursuant to Part 15 of the FCC Rules. These limits are designed to provide reasonable protection against harmful interference in a residential installation. This equipment generates, uses, and can radiate radio frequency energy and, if not installed and used in accordance with the instructions, may cause harmful interference to radio communications. However, there is no guarantee that interference will not occur in a particular installation.

If this equipment does cause harmful interference to radio or television reception, which can be determined by turning the equipment off and on, the user is encouraged to try to correct the interference by one or more of the following measures:

- Reorient or relocate the receiving antenna
- Increase the separation between the equipment and receiver
- Connect the equipment into an outlet on a circuit different from that to which the receiver is connected
- Consult the dealer or an experienced radio/TV technician for help

This equipment complies with FCC radiation exposure limits set forth for an uncontrolled environment. This equipment should be installed and operated with a minimum distance of 20 cm between the transmitter's radiating structure(s) and the body of the user or nearby persons.

**Note:** Any changes or modifications to this device that are not expressly approved by the manufacturer will void the warranty and the user's authority to operate the equipment.

FCC ID: 2AC7Z-ESPC3MINI1

## IC NOTICE

This device complies with Industry Canada license-exempt RSS standards. Operation is subject to the following two conditions: (1) this device may not cause interference; and (2) this device must accept any interference, including interference that may cause undesired operation of the device.

## RF EXPOSURE STATEMENT

This equipment meets the SAR evaluation limits given in RSS-102 Issue 5 requirements at the minimum separation distance of 15 mm to the human body.

**Note:** Any changes or modifications to this device that are not expressly approved by the manufacturer, will void the warranty and the user's authority to operate the equipment.

IC ID: 21098-ESPC3MINI1

## ADDITIONAL RATINGS:

Purpose of Control: Manual Control

Method of Providing Earthing of Control: Ground Terminal

Action Control Type: 1

Disconnection Type: Micro

Pollution Degree: 2

Rated Impulse Voltage: 2500V



Wi-Fi® is a registered trademark of Wi-Fi Alliance®.

# warranty

This product is warranty under normal use against deficits in workmanship and materials for one (1) year following your purchase. If the product fails due to a manufacturing defect during normal use, contact the store where purchased or contract technical support at 1-877-833-3303.

A dated sales receipt must be provided for all replacement requests (legible copies are acceptable).

Additional warranty details are available at <http://www.legrand.us> under your device's product page.

# specifications

Load	Rating
Resistive	120VAC, 60Hz, 1800W
Incandescent/halogen	120VAC, 60Hz, 1800W
Standard Ballast	120VAC, 60Hz, 1800VA
Electronic Ballast	120VAC, 60Hz, 5A
Motor	120VAC, 60Hz, ½ HP

Legrand reserves the right to change specifications without notice.

# customer support:

Please contact our customer support team for assistance.

Available Monday – Friday, 8AM – 6PM ET (Excluding Holidays)

Phone: (877) 833-3303

E-mail: [smartlights@legrand.us](mailto:smartlights@legrand.us)



**Legrand, North America**

50 Boyd Avenue  
Syracuse, NY 13209  
1-877-833-3303  
[www.legrand.us](http://www.legrand.us)