

# 18" FLOOR FAN

---

## USER MANUAL – FF18S-B

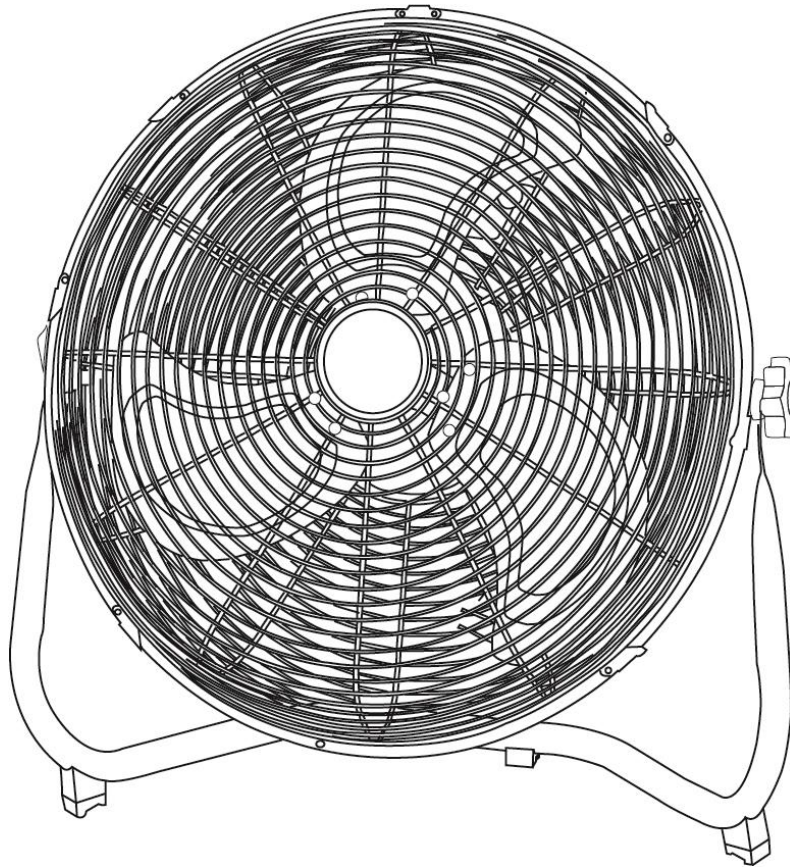

**PLEASE READ AND SAVE THESE INSTRUCTIONS**

*Attention: Pictures in this manual are for reference only.*

MADE IN CHINA

## INTENDED USE

Use only with electrical wiring that is in good working order and that meets applicable codes and ordinances. If you have any questions about whether your wiring is adequate, consult a qualified electrician.

While using your fan, you should follow the IMPORTANT INSTRUCTIONS listed below. As part of those instructions, we have used the word "WARNING" to indicate the level of hazard: WARNING indicates a hazard which, if not avoided, could result in injury or death.

## IMPORTANT INSTRUCTIONS

As with all electrical appliances, basic safety precautions should always be followed to reduce the risk of electric shock, fire, or injury to persons, including the following precautions:

- Read all the instructions before using this fan.
- Use this fan only as described in this manual. Any other use not recommended by the manufacturer may cause electrical shock, fire or injury to persons.
- Do not operate the fan with a damaged power cord or after the fan malfunctions or has been dropped in any manner.
- Use of extreme caution is necessary when any fan is used by or near children, disabled persons or pets and whenever the fan is left operating unattended.
- Do not place the fan on a small, unlevel, uneven or any surface which might allow fan to tip or fall.
- For proper operation, the fan should be placed on a smooth, non-combustible, level surface.
- Always unplug the fan when not in use, when moving from place to place, when assembling or disassembling parts, and before cleaning.
- The use of attachments, not recommended or sold by the Manufacturer may cause hazards.
- Do not use it outdoors.
- Do not use the fan in the window. Rain may cause electrical hazard (for non-window models).
- Do not operate the fan with blade guards or any safety device removed.
- Avoid the use of extension cords due to the risk of

fire. If an extension cord must be used, the cord must be a minimum of 14 AWG and rated no less than 1875 watts.

- Do not run the power cord under carpeting. Do not cover the cord with throw rugs, runners or the like. Arrange cord away from traffic area where it will not be tripped over.
- Do not insert or allow any object to enter any openings on the fan. Doing so may cause electric shock and/or fire hazard. Avoid contact with moving parts.
- This appliance is not intended for use by persons (including children) with reduced physical, sensory or mental capabilities or lack of experience and knowledge, unless they have been given supervision or instruction concerning use of the appliance by a person responsible for their safety.
- Children should be supervised to ensure they do not play with the appliance.

## READ & SAVE THESE INSTRUCTIONS

### **WARNING: Shock Hazard**

Use your fan only in dry environments. This fan is not intended for use in a bathroom, laundry area, or similar locations, or near sinks, washing machines, swimming pools or other sources of water. Never locate a fan where it may fall into a bathtub or other water receptacle. Do not use it in damp environments such as flooded basements.

### **WARNING: Hot Surfaces**

Do not touch fan motor when in use. This motor is hot when in use. To avoid burns, do not let bare skin touch hot surfaces.

### **WARNING: Fire Hazard**

Fans have arcing or sparking parts inside. Do not use near combustible materials or flammable gases or sources of heat. DO NOT USE in areas where gasoline, paint or flammable materials are used or stored. To prevent a possible fire, do not block air intake or exhaust in any manner. Do not insert or allow foreign objects to enter any ventilation or exhaust opening as this may cause an electric shock, fire, or damage to the fan.

**WARNING: Electrical Shock Hazard**

Do not use it with damaged cord or plug. Use with adequate electrical system that is up to code.

**CAUTION: to Prevent Electric Shock**, this product has a three-prong grounded plug that must be inserted into a matching properly grounded outlet to reduce the risk of electrical shock. Do not attempt to defeat this safety feature.

**WARNING: to Reduce the Risk of Fire or Electric Shock**, do not use this product with any solid-state speed control device.

**WARNING: Cancer and Reproductive Harm-**  
[www.P65Warnings.ca.gov](http://www.P65Warnings.ca.gov)

**USAGE**

**Fan Operation:** Always operate the fan in the upright position following all instructions and recommendations listed in this manual.

**Fan Location:** Place the fan in an area of the room that will provide proper fan cooling.

**Fan Connection:** Plug fan directly into 120 volt A.C., 60 Hz wall outlet. Be sure the plug fits tightly in the outlet. A loose connection may cause overheating and damage to the plug or fan.

**Note:** To prevent overloading a circuit, do not plug the fan into a circuit that is servicing other electrical needs.

**OPERATING FAN**

Place fan on stable level surface. Plug fan into properly grounded outlet. Select air speed by pushing the buttons on the back of the fan. 0 meaning off, 1 for Low, 2 for Medium and 3 for High.

**Adjusting Fan Tilt:** To adjust the tilt angle, loosen the screw knob. After adjustment, retighten the screw knob.

It is normal for the motor to feel warm to the touch after continuous operation. This fan features a thermostat that will automatically shut off if it overheats. If this happens, unplug the fan from the

outlet immediately.

**FAN CRADLE ASSEMBLY**

Simple assembly is required to use this fan.

1. Insert one cradle base to other one by overlapping the screw holes A and B on the two cradle bases, see Fig. 1&2.
2. Insert the screw with washers and hex nut through the holes A and B in the sequence of screw, washer, cradle base, washer then hex nut, see Fig.3.
3. Tight up the hex nut and shake the two bases to check if the bases are assembling tight enough.
4. Loosen the screw knobs on the two sides of the fan head.
5. Overlap the screw hole inside the fan shells, the rubber ring and the hole of the cradle base. Then insert back the screw knob and tight up, see Fig.4.
6. Repeat step 5 on the opposite side of fan.

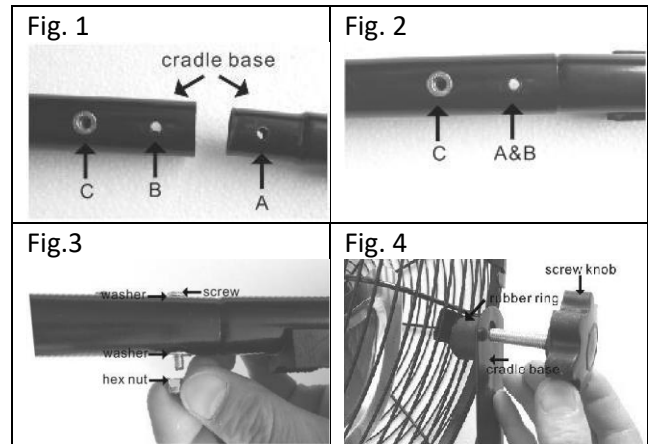

**WALL MOUNTED ASSEMBLY**

When you want to use the fan as a wall mounted fan, you should assemble using the following steps.

1. Confirm the wall height as you need, then mark down the position the mounting bracket would be located, see Fig.1.
2. Drill the three holes on the wall. Holes dimension should be 5/16 inch diameter and 1-3/4inch depth.
3. Insert the plastic anchors into the holes, see Fig.2.

4. Overlap the three holes on the mounting bracket with the holes onto the wall, and then insert the screws E into the holes, and tight them up, see Fig.3.
5. Overlap the hole C on the cradle base with the bigger hole D on the mounting bracket and then insert the screw knob and tight it up, see Fig.4.

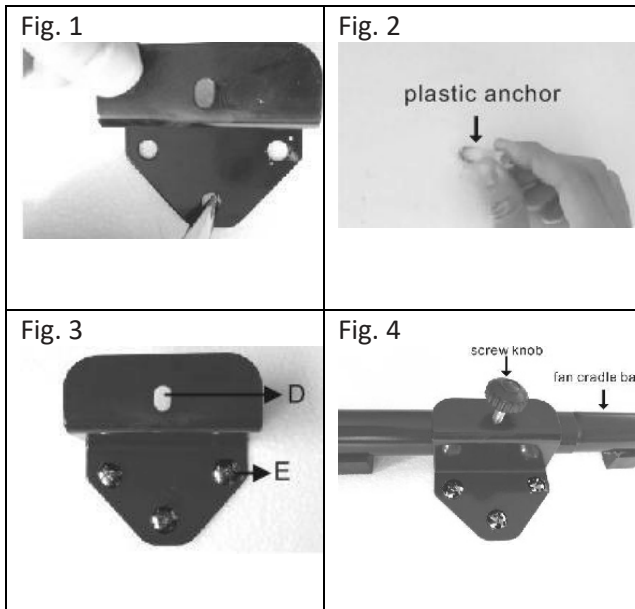

**Care and Maintenance Cleaning:** CAUTION-Before cleaning the fan be sure to disconnect power cord from the plug. Clean the grille surface with a clean damp cloth. Do not use harsh chemical or abrasive cleaners. DO NOT IMMERSE THE FAN OR ANY WIRES IN WATER. Replace front grille before fan use. Allow fan to dry completely before use. Periodic grille cleaning with a vacuum will prevent dust build up. The motor is sealed and does not require any interior maintenance, cleaning or lubrication.

**Maintenance:** The Internal motor bearings are permanently lubricated at the factory and do not require any additional lubrication.

**Repair:** DO NOT OPERATE THE FAN WITHOUT THE GRILLE IN PLACE. DO NOT USE THE FAN IF IT HAS MALFUNCTIONED OR BECOME DAMAGED IN ANY WAY.

**Storage:** Keep original carton for storage of the fan. Coil and tie the power cord to avoid damage during storage.