



|                |
|----------------|
| Catalog Number |
| Notes          |
| Type           |

Contractor Select™

# TLS ODP

Twist-to-Lock Sensor, Outdoor



Inspired by TLS Industrial High-Bay sensor's reception, the SensorSwitch™ TLS ODP twist-to-lock sensor extends the same reliable technology to exterior lighting applications. Designed for outdoor motion detection and dusk to dawn photocell control, the TLS ODP brings energy savings and controls to parking lots, pathways, and other outdoor areas.

Like its high-bay counterpart, the TLS ODP offers a field-installable, tool-less twist-to-lock design with no wiring required for assembly. It comes pre-configured with default settings for quick startup, while custom configurations can be applied through the SensorSwitch Infrared Wireless Remote Programmer (IWP).

With bi-directional IR communication and passive powerless programming, installers and facility teams can adjust settings from the ground—or still in its packaging—delivering flexibility, security, and efficiency in outdoor lighting installations and controls.

**FEATURES:**

- Dusk to Dawn photocell control.
- Adjustable lighting control settings: occupancy time, high trim, and photocell setpoint.
- Support ingress protection, IP66.
- Configurable from the floor using IWP bi-directional remote.
- Support passive powerless programming, allows programming while unpowered via RFID.
- Motion detection tested per NEMA WD 7-2011.



| Catalog Number | UPC            | Description                   | Detection Type    | Coverage          | Voltage Type | Color | Voltage   | Pallet Quantity |
|----------------|----------------|-------------------------------|-------------------|-------------------|--------------|-------|-----------|-----------------|
| TLS ODP BK     | 00198935649941 | Twist-to-Lock Sensor, Outdoor | PIR and Photocell | Large Motion 360° | Low          | Black | 12 to 24V | 8640            |

| <b>Accessory Series:</b> Order as separate catalog number. |                          |         |                |
|--|--------------------------|---------|----------------|
| Catalog Number   | Description              | CI Code | UPC            |
| IWP  | Infrared Wireless Remote | *289T19 | 00197590758241 |



## Specifications

### ENVIRONMENTAL:

Temperature: -40 to 80°C

Max Humidity: up to 90% non-condensing

Ingress Protection: IP66

### RATING:

Input: 12-24VDC

Output: 0-10V Sink Current: 6mA

### OUT-OF-THE-BOX, FIELD-SETTABLE DEFAULTS:

Occupancy: 10-minutes

High Trim: 100%

Photocell setpoint: 3 fc

### OUT-OF-THE-BOX, FIXED DEFAULTS:

Low Trim: 30% (static value)

Fade Down Rate<sup>1</sup>: 30 seconds

Photocell Transition<sup>2</sup> Time Off : 5 minutes

Photocell Transition<sup>3</sup> Time On: 30 seconds

1. Time period from when motion time delay expires to when lights are at low trim level.

2. The time period after the photocell measures a light level above the set-point (+ deadband) that it will turn lights off.

3. The time period after the photocell measures a light level below the set-point that it will turn lights on

### DIMENSIONS:

Height: 0.88 inches

Diameter: 2.14 inches

### WARRANTY:

5-year limited warranty. This is the only warranty provided and no other statements in this specification sheet create any warranty of any kind. All other express and implied warranties are disclaimed. Complete warranty terms located at:

[www.acuitybrands.com/support/warranty/terms-and-conditions](http://www.acuitybrands.com/support/warranty/terms-and-conditions)

**Note:** Actual performance may differ as a result of end-user environment and application. Specifications subject to change without notice.

### COVERAGE PATTERN:

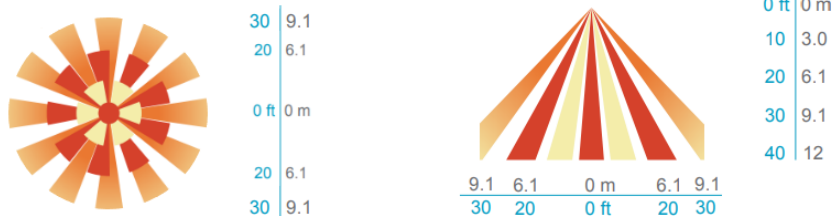

Remove Cap

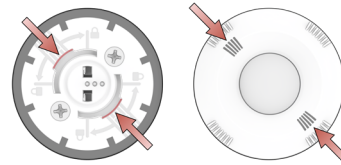

Align Sensor



Twist and Lock

## Installation

While the luminaire image may vary, the control installation is the same.

- Reliable detection of large motion (e.g. pedestrian walking traffic) up to 30 ft. (9.1 m) mounting height
- Reliable detection of extra-large motion (e.g. vehicular) up to 40 ft. (12 m) mounting height
- Tested to NEMA WD 7-2011