



# Heavy Duty Cable Management Solutions

Expert solutions to create  
improved designs and lower  
total installed cost

**PANDUIT**<sup>®</sup>

# Panduit is your wire management solutions partner for the harshest, heavy duty applications

## Panduit provides expertise, services, and products for:

- Optimized wire management design
- New product development
- Problem solving and process improvement

## Ideally suited for applications, including:

- Heavy truck
- Construction equipment
- Agricultural equipment
- Bus
- Specialty trucks, such as dump trucks, concrete trucks, utility trucks

Draw on our expertise to help you reduce wire management costs and hassle!



# Table of Contents

---

<b>Cable Ties.....</b>	<b>5</b>
<b>Chassis Mount Ties and Spacers.....</b>	<b>8</b>
<b>Stud Mounts for Heavy Cross Section Cable Ties .....</b>	<b>9</b>
<b>Clamps.....</b>	<b>9</b>
<b>Tie Mounts .....</b>	<b>12</b>
<b>Fir Tree Push Mounts.....</b>	<b>17</b>
<b>Edge Clips.....</b>	<b>19</b>
<b>Cable Tie Installation Hand Tools .....</b>	<b>22</b>
<b>Complete Your Bundle .....</b>	<b>23</b>

## Heavy Duty Cable Management Solutions

Whether you design systems for agricultural machinery or heavy-duty construction equipment, your electrical connections are continuously subjected to extreme conditions and harsh environments. Breakdowns can occur unless each and every component can withstand the rigors of your challenging operating environment. Panduit can help you avoid downtime, costly rework or even equipment recalls. We offer the widest range of products specifically designed for your toughest challenges, from severe temperatures and vibration to extreme mechanical stress.

Our R&D capabilities offer world-class products that are designed to meet or exceed industry standards. Look to Panduit engineered solutions to solve your manufacturing problems, application needs, and new product development to reveal new opportunities for operational efficiencies and cost-savings. Partner with Panduit and keep your systems operating dependably. We're wired for the way you work.

## Expertise to engineer profitability

Engineers face cable management decisions impacting the performance, quality, and migration plans of their vehicle platforms. Panduit is equipped to help. Let our expertise and robust heavy duty cable management products help you lower total installed costs.



### Consultative Engineering

For the many design decisions and application issues encountered, help is needed to identify the cable management products best suited for each application. Panduit provides consultative engineering assistance and best practice sharing to engineers working on truck, bus, and heavy equipment applications.



### Innovative New Products

Panduit has expanded our offering of robust heavy duty cable management products to cover even more applications for OEM truck, bus and heavy equipment manufacturers. Always innovating, Panduit continues to design and launch new products for these demanding applications.



### Tooling Support

In addition to a broad range of application specific heavy duty cable management products, Panduit also offers installation tooling and tooling services to meet the highest OEM specifications.

# Cable Ties

## Double Clamp Cable Ties

The Double Clamp cable ties provide a cost effective way to secure and separate parallel hoses, tubing, wires and wiring bundles in an easy to install one-piece design. The Double Clamp cable tie has a strong 150 lbs. loop tensile strength to provide secure support for even high load applications. This new cable tie is ideal for heavy duty applications such as Truck and Heavy Equipment.

### Key Features and Benefits

- Provides reliable holding power for demanding applications, delivering consistent 150 lb. loop tensile strength for heavy-duty cable and hose management
- Built-in spacing helps reduce abrasion and wear between parallel bundles, supporting longer service life and improved system reliability
- Made from impact-modified, heat-stabilized Nylon 6.6 that resists UV exposure, heat, and outdoor environmental conditions
- Designed to perform in extreme environments, with operating temperatures ranging approximately from -76°F to 239°F (-60°C to 115°C)
- One-piece, easy install design simplifies installation by combining clamping and spacing into a single tie



Part Number	Length In. (mm)	Width In. (mm)	Thickness In. (mm)	Max. Bundle Diameter In. (mm)	Min. Loop Tensile lbs. (N)	Recommended Installation Tool	Std. Pkg. Qty.	Std. Ctn. Qty.
PLDC1.5EH-C350	13.1 (333)	0.5 (12.70)	0.055 (1.4)	1.3 (33)	150 (667)	GS4EH-E, GTH-E*, PPTEH	100	500
PLDC2.5EH-C350	19.2 (489)			2.3 (58)				

\* GTH-E tools starting with Date Code L18 now cut through these Double Clamp ties (PLDC1.5EH and PLDC2.5EH). Date Code is etched on the red trigger handle. These tools come equipped with a wider blade that will cut through these extra heavy thin ties. Tools prior to the L18 date code do not have the wide blade.



## Double Loop Cable Ties

Looking for a labor-saving alternative to butterflyed cushioned clamps when securing hoses and wire bundles? Our Double Loop Cable Ties are the perfect solution. They feature a double-loop configuration that allows each bundle to be independently secured, reducing the need for multiple ties or additional components. Ideal for applications that require dependable bundle support and efficient installation.

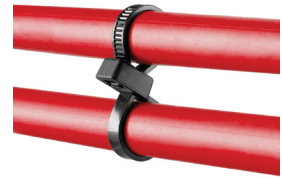

### Key Features and Benefits

- Designed to secure and separate two bundles of cables, wires, hoses, or tubing in a single installation, supporting organized parallel routing
- Fast and economical method for bundling applications where two parallel runs must be managed efficiently
- Available in heavy cross-section designs to provide the strength required for higher-load applications
- Manufactured from Nylon 6.6 materials offered in weather-resistant and heat-stabilized options for application versatility
- Designed for use with Panduit cable tie installation tools, supporting consistent installation and controlled tensioning

Part Number	Length In. (mm)	Width In. (mm)	Thickness In. (mm)	Max. Combined Bundle Dia. D1 + D2 In. (mm)	Min. Loop Tensile lbs. (N)	Recommended Installation Tool	Std. Pkg. Qty.	Std. Ctn. Qty.
<b>WEATHER-RESISTANT NYLON 6.6 – LIGHT-HEAVY CROSS SECTION</b>								
PLB4H-TL0	14.4 (366)	0.30 (7.62)	0.075 (1.9)	3.60 (91)	120 (534)	GTH-E, GS4H-E, GS4EH-E, PTH, STH2, ST3EH	250	2500
<b>WEATHER-RESISTANT NYLON 6.6 – STANDARD CROSS SECTION</b>								
PLB2S-C0	7.6 (193)			1.80 (45.7)				
PLB3S-C0	11.8 (300)	0.19 (4.8)	0.052 (1.3)	3.0 (76.2)	50 (222)	GTS-E, GS2B-E, GTH-E, GS4H-E, PTS, PTH, PPTS, STS2, STH2	100	1000
PLB4S-M0	14.8 (376)			4.10 (104.1)			1,000	5000

## Triple Loop Cable Ties

Triple Loop Cable Ties are designed to secure and separate three cable, wire, or hose bundles using a single tie. The triple loop design allows multiple bundles to be fastened together or kept distinct in one installation, making them a fast and economical solution for organized multi-bundle routing.



### Key Features and Benefits

- Enables fastening of three cable, wire, or hose bundles together or separately, reducing the number of ties needed
- Provides a quick, cost-effective method to secure and organize multiple bundles in a single installation
- Designed with an extra-heavy cross-section to support higher load requirements in heavy-duty environments
- Manufactured from weather-resistant Nylon 6.6, making the tie suitable for indoor and outdoor use

Part Number	Length In. (mm)	Width In. (mm)	Thickness In. (mm)	Max. Combined Bundle Dia. D1 + D2 + D3 In. (mm)	Min. Loop Tensile lbs. (N)	Recommended Installation Tool	Std. Pkg. Qty.	Std. Ctn. Qty.
<b>EXTRA-HEAVY CROSS SECTION</b>								
PL3B5EH-C0	20.0 (508)	0.5 (12.7)	0.075 (1.9)	5.0 (127)	125 (556)	GS4EH-E, ST3EH	100	1000

## Wide Strap Extra Heavy Cable Ties

The Wide Strap Extra Heavy cable ties provide an easy to install way to secure hoses, tubing, wires and wiring bundles. These cable ties feature a wide, thin body that is more flexible and easier to install than the typical Heavy and Extra-Heavy Cross section ties. The Wide Strap Extra Heavy cable tie has a strong 120 lbs. loop tensile strength to provide secure support for even high load applications. This new cable tie is ideal for heavy duty applications such as truck and heavy equipment.

### Key Features and Benefits

- Flexible cable tie body provides easier insertion and installation than other heavy and extra heavy cross section cable ties
- The wide 0.5" design of the cable tie body minimizes pinching on hoses and tubing compared with typical cable ties
- Impact-modified, heat-stabilized, weather-resistant Nylon 6.6, 239°F (115°C)



Part Number	Length In. (mm)	Width In. (mm)	Thickness In. (mm)	Max. Combined Bundle Dia. In. (mm)	Min. Loop Tensile lbs. (N)	Recommended Installation Tool	Std. Pkg. Qty.	Std. Ctn. Qty.
PLWS2EH-TL350	9.1 (231)	0.5 (12.7)	0.06 (1.4)	2.25 (57.2)	120 (534)	GS4EH-E, GTH-E*, PPTEH	250	2500
PLWS3EH-TL350	12.1 (307)			3.25 (82.6)				
PLWS4EH-TL350	15.1 (384)			4.13 (105)				

\*GTH-E tools starting with Date Code L18 now cut through these Wide Strap ties (PLWS2EH, PLWS3EH, PLWS4EH). Date Code is etched on the red trigger handle. These tools come equipped with a wider blade that will cut through these extra heavy thin ties. Tools prior to the L18 date code do not have the wide blade.

## Cable Tie PLT4H - Flexible Heavy Cross Section

Cable Tie PLT4H provides excellent tensile strength that is expected with a Heavy Cross Section design. These cable ties install quickly and more easily than the typical Heavy Cross section ties. This innovative design allows no-slip gripping of the tip along with the ability to cinch with one hand. Installation with Panduit GTH-E or GS4H-E cable tie hand tools provides faster installation, exact bundle tension and smooth tie cut off. This flexible heavy cross section is ideal for heavy duty applications such as truck, bus, and heavy equipment.

### Key Features and Benefits

- Allows installation of the cable with one hand
- No-slip gripping of tip on initial insertion
- Provides a low thread force for quick and easy installation to improve productivity and worker safety
- Easier, faster installation with lower installer effort to install ties to proper tension settings
- Available in both weather-resistant (-0) and heat-stabilized (-30) materials for application versatility



Part Number	Length In. (mm)	Width In. (mm)	Thickness In. (mm)	Max. Bundle Dia. In. (mm)	Min. Loop Tensile lbs. (N)	Recommended Installation Tool	Std. Pkg. Qty.	Std. Ctn. Qty.
PLT4H-TL0/147	14.5 (368)	0.30 (7.6)	0.06 (1.5)	4.11 (104.5)	120 (534)	GTH-E, GS4H-E	250	2500
PLT4H-TL30/147		0.06 (1.5)						

# Chassis Mount Ties and Spacers

## Chassis Mount Ties

Chassis Mount Ties and Spacers are designed to secure and position cables, wires, and harnesses directly to a chassis or frame in heavy-duty applications. These solutions help maintain proper routing and separation while withstanding extreme conditions such as vibration, mechanical stress, and harsh operating environments commonly found in transportation and heavy equipment systems.

### Key Features and Benefits

- Eliminates the need for separate fasteners to reduce costs and decrease installation time
- Remains adjustable and releasable until tie is tensioned and cut off
- Installs easily with Panduit hand-operated tools
- Engages clearance hole with optional centering pilot (2 designs) to prevent tie from shifting or abrading during vehicle operation



### Three Easy Steps

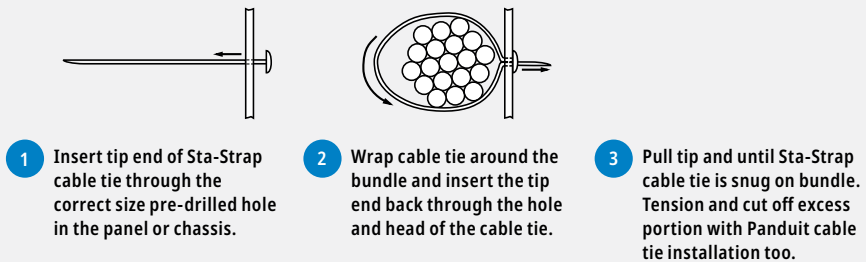

Part Number	Length In. (mm)	Width In. (mm)	Thickness In. (mm)	Hole Diameter Range In. (mm)	Max. Bundle Dia. In. (mm)	Min. Loop Tensile lbs. (N)	Recommended Installation Tool	Std. Pkg. Qty.	Std. Ctn. Qty.
<b>WITHOUT CENTERING PILOT</b>									
SSPM2.5H-L300	10.1 (257)	0.30 (7.6)	0.062 (1.6)	0.316 – 0.820 (8.0 – 21.0)	2.76 (70)	120 (534)	GTH-E, GS4H-E, GS4EH-E, PTH, STH2, ST3EH	50	2500
SSPM4H-L300	14.8 (376)				4.0 (102)				
<b>WITH CENTERING PILOT</b>									
SSPM2.5HP-TL300	10.1 (257)	0.30 (7.6)	0.062 (1.6)	0.440 – 0.820 (11.2 – 21.0)	2.76 (70)	120 (534)	GTH-E, GS4H-E, GS4EH-E, PTH, STH2, ST3EH	250	2500
SSPM4HP-TL300	14.8 (376)				4.0 (102)				
<b>WITH LONG CENTERING PILOT</b>									
SSPM4HLP-TL300	14.8 (376)	0.30 (7.6)	0.062 (1.6)	0.440 – 0.820 (11.2 – 21.0)	4.0 (102)	120 (534)	GTH-E, GS4H-E, GS4EH-E, PTH, STH2, ST3EH	250	2500

# Stud Mounts for Heavy Cross-Section Cable Ties

Secure cables to studs or bolts with our stud mounted cable tie mount so your indoor or outdoor bundles stay anchored with minimal installation effort.

## Key Features and Benefits

- Easily applied to bolts or studs with a light hammer blow or turing of the mount
- Designed for use with cable ties to route and secure cable bundles, air, water, and hydraulic lines



Part Number	Used with Cable Ties	Material	Color	Environment	Mounting Method (Hammer-on)	Std. Pkg. Qty.	Std. Ctn. Qty.
TMSTLHS6-M0	M, I, S, HS, LH	Impact-modified, weather-resistant Nylon 6.6	Black	Indoor/Outdoor	1/4" stud dia. (6mm)	1000	-
TMSTLHS8-M0					5/16" stud dia. (8mm)		5000
TMSTHS10-D0	M, I, S, HS, LH, H				3/8" stud dia. (10mm)	500	-
TMSTHS11-D0					7/16" stud dia. (11mm)		
TMSTHS12-D0					12mm stud dia.		
TMSTHS13-D0					1/2" stud dia. (13mm)		
TMSTHS16-D0					5/8" stud dia. (16mm)		
TMSTHS19-D0					3/4" stud dia. (19mm)		

# Clamps

## High Voltage Cable Clamps

Specifically engineered to manage and secure high-voltage battery cable installations in heavy-duty electric vehicle applications, these clamps feature robust, heat-stabilized housings with compressible inserts designed to protect cable insulation while allowing controlled movement during manufacturing and service.

## Key Features and Benefits

- Anti-rotation feature (locks clamp in place to protect cables against sudden torque)
- Clamp halves stay together but provide "relief" to help position over cables until final bolt securement to frame
- Made of glass-filled nylon for durability
- Sized for M6 bolt
- Stackable for layered cable runs



[Product Highlights EV Application Video](#)

Part Number	Diameter Range In. (mm)	Color	Configuration	Std. Ctn. Qty.
HV15CC1-C376	0.43 - 0.59 (11 - 15)	Blue	Single	100
HV15CC2-C376			Two position	
HV19CC1-C370	0.59 - 0.75 (15 - 19)	Black	Single	
HV19CC2-C370			Two position	
HV23CC1-C378	0.75 - 0.91 (19 - 23)	Gray	Single	
HV23CC2-C378			Two position	

## Corrugated Loom Tubing Clamps

Designed to secure and route corrugated loom tubing that protects electrical cables, hydraulic lines, or pneumatic hoses in heavy-duty vehicle applications, these clamps mount directly to a frame rail and feature internal ribs that provide secure contact with corrugated loom tubing, helping maintain routing and reduce abrasion in demanding operating environments.



### Key Features and Benefits

- Ribs lock corrugated loom tubing and keep from sliding
- One, Two or Three position configurations
- Sized for M8 bolts and includes thread-retaining feature to secure bolt to clamp prior to fixing
- Made of glass-filled nylon for durability in rugged environments
- Rated for continuous use temperature up to 275°F (135°C)



[EV Application Video](#)

Part Number	Description	Package Qty.	Paired Clamps Qty. per Package
CLC62X1S8TL370	1-Position 5/8" Corrugated Loom Clamp	250	125
CLC75X1S8TL370	1-Position 3/4" Corrugated Loom Clamp		
CLC88X1S8TL370	1-Position 7/8" Corrugated Loom Clamp		
CLC100X1S8TL370	1-Position 1" Corrugated Loom Clamp	250	125
CLC62X2S8TL370	2-Position 5/8" Corrugated Loom Clamp		
CLC75X2S8TL370	2-Position 3/4" Corrugated Loom Clamp		
CLC88X2S8TL370	2-Position 7/8" Corrugated Loom Clamp	100	50
CLC100X2S8TL370	2-Position 1" Corrugated Loom Clamp		
CLC62X3S8C370	3-Position 5/8" Corrugated Loom Clamp		
CLC75X3S8C370	3-Position 3/4" Corrugated Loom Clamp	100	50
CLC88X3S8C370	3-Position 7/8" Corrugated Loom Clamp		
CLC100X3S8C370	3-Position 1" Corrugated Loom Clamp		

### Range-Taking Mount with Bracket

Providing a versatile solution for securing and routing electrical cables, as well as hydraulic or pneumatic hoses, in heavy-duty vehicle applications, this system combines a range-taking cable tie mount with a metal mounting bracket, enabling high-torque fastening while accommodating a wide range of bundle sizes. The modular design allows for horizontal or vertical routing, helping reduce part count and inventory compared to traditional fastening methods.

#### Key Features and Benefits

- Mount can be clocked to orient to cable direction
- Mount sized to accommodate 1" to 5" bundle diameters
- Mount made of impact-modified, heat-stabilized, UV-resistant nylon
- Mount can handle temperature rating up to 239°F (115°C) continuous use
- Brackets are made of 14-gauge zinc plated steel for durability
- Brackets sized to accommodate 3/8" (M10) bolt size

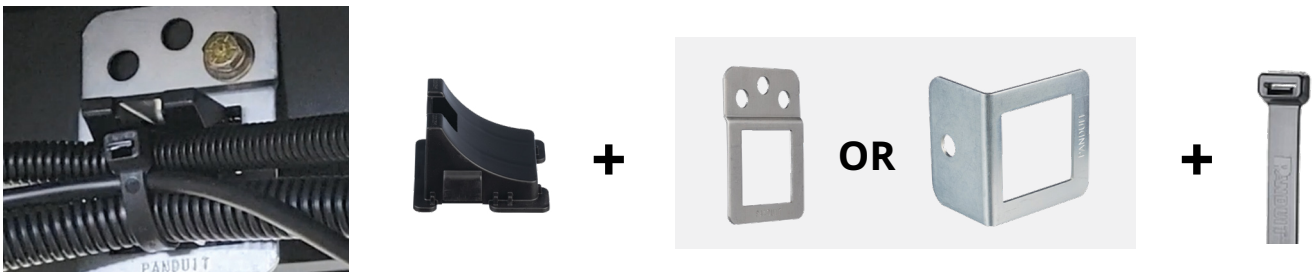

Part Number	Description	Package Qty.
RTCM3EBL-L350	Range-taking mount with 3" cradle	50
RTCBES10-TL	Flat bracket	250
RTCBE90S10-C	90° bracket	100

### Push-in Cradle Mount

The Push-in Cradle Mount provides an excellent wire management solution, especially suited for managing battery power cables sized 2 AWG up to 2/0 affixed in an array over a bracket, frame, or other structure.



#### Key Features and Benefits

- Pre-configured with PLT2S cable tie
- Provides a secured nesting surface "cradle" for cables
- Cradle area is substantially raised above surface of frame to keep cables raised and offset from metal surface
- Mount made of impact-modified, heat-stabilized, UV-resistant nylon
- Mount can handle temperature rating up to 239°F (115°C) continuous use

Part Number	Description	Package Qty.
TCM1X63-2S-D350	Push-in mount and cable tie assembly	500

## Tie Mount Wing Clamp

The Tie Mount Wing Clamp provides a secure and reliable hold for cables, hoses, and tubing, making it ideal for industrial applications, construction equipment, and solar installations.



### Key Features and Benefits

- Cradle “saddle” helps stage cables for final securement with cable tie
- Works with cable tie to give reinforced securing means over the bundle; can accommodate 5” (or more) bundle capacity
- Secure to mounting surface with 1/4” (M6) bolt; also designed to secure over HV clamps
- Mount made of impact-modified, heat-stabilized, UV-resistant nylon
- Mount can handle temperature rating up to 239°F (115°C)

Part Number	Description	Package Qty.
TMWCS6-C350	Tie mount wing clamp with M6 mounting	100

## Tie Mounts

### Extra Heavy Tie Mounts

We offer many accessories for mounting Wide Strap Extra Heavy cable ties, including extra-heavy screw applied cable tie mounts (TMEH2). In addition to these accessories, the Wide Strap Extra Heavy cable ties are also available pre-assembled.



### Key Features and Benefits

- Extra-heavy, screw-applied tie mount for securing large/heavy wire, cable, or hose bundles—helps make installation more efficient and cost effective
- Unique cradle design provides maximum stability for the cable bundle
- Rugged material: impact-modified, heat-stabilized, weather-resistant Nylon 6.6
- Compatible cable tie cross-sections: M, I, S, HS, LH, H, EH

Part Number	Used with Cable Ties‡	Material	Color	Environment	Mounting Method	Std. Pkg. Qty.	Std. Ctn. Qty.
TMEH2S5-D350	M, I, S, HS, LH, H, EH	Impact-modified, heat-stabilized, weather-resistant Nylon 6.6	Black	Indoor/Outdoor	#10 (M5) screw	500	2000
TMEH2S6-D350					1/4 (M6) screw		
TMEH2S8-D350					5/16 (M8) screw		

‡Cable tie cross section sizes: M = Miniature, I = Intermediate, S = Standard, HS = Heavy-Standard, LH = Light-Heavy, H = Heavy, EH = Extra-Heavy

## High and Medium Torque Tie Mounts

These heavy-duty mounts help secure wires, cables, and hose bundles, making installation more efficient and cost effective on trains, subways, heavy equipment, trucks, and buses.

### Key Features and Benefits

- Rugged, highly durable materials suited for heavy-duty applications
- Heat-stabilized, UV weather-resistant, impact-modified Nylon 6.6 material
- Unique cradle design that provides maximum stability to help route and support large diameter and heavy cable bundles



Part Number	Used with Cable Ties‡	Material	Torque Ft.-lbs.	Color	Environment	Mounting Method	Std. Pkg. Qty.
TMEH4S8-D350	M, I, S, HS, LH, H, EH, WS	Impact-modified, heat-stabilized, weather-resistant Nylon 6.6 with zinc-plated steel insert	114	Black	Indoor/Outdoor	5/16" (8mm) bolt	500
TMEH4S10-D350						3/8" (10mm) bolt	
TMEH4S13-D350						1/2" (13mm) bolt	
TMEH3S8-D350		Impact-modified, heat-stabilized, weather-resistant Nylon 6.6	40			5/16" (8mm) bolt	
TMEH3S10-D350						3/8" (10mm) bolt	
TMEH3S13-D350						1/2" (13mm) bolt	



### Screw Applied Tie Mounts

Stabilize demanding bundles with our screw applied cable tie mounts featuring a cradle design to keep your cable close to the surface for maximum support.



#### Key Features and Benefits

- Unique cradle design provides maximum stability for cable bundle
- Route and support large diameter and heavy cable bundles

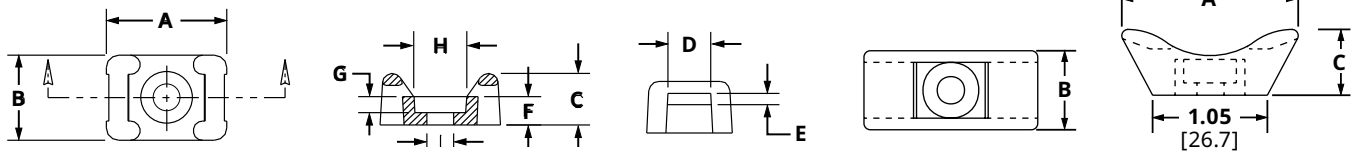

Part Number	Used with Cable Ties‡	Material	Color	Environment	Mounting Method	Std. Pkg. Qty.	Std. Ctn. Qty.
TMEH-S8-Q0	M, I, S, HS, LH, H, EH	Weather-resistant Nylon 6.6	Black	Indoor/Outdoor	#8 (M4) Screw	25	250
TMEH-S10-Q0					#10 (M5) Screw		
TMEH-S25-Q0					1/4 (M6) Screw		
TMEH-S10-C100	M, I, S, LH	Weather-resistant Polypropylene	Green	Indoor	#10 (M5) Screw	100	500
TMEH-S10-C109		Polypropylene			#10 (M5) Screw		
TM3S8-C	M, I, S, LH		Natural	Indoor	#8 (M4) Screw		
TM3S10-C					#10 (M5) Screw		
TM1S6-M0	M	Weather-resistant Nylon 6.6	Black	Indoor/Outdoor	#6 (M3) Screw	1000	5000
TM2R6-M0	M, I, S				3/16 Rivet		
TM2S6-M0					#6 (M3) Screw		
TM2S8-M0					#8 (M4) Screw		
TM3R6-M0	M, I, S, LH				3/16 Rivet		
TM3S10-M0					#10 (M5) Screw		
TM3S25-M0					1/4 (M6) Screw		

‡Cable tie cross section sizes: M = Miniature, I = Intermediate, S = Standard, HS = Heavy-Standard, LH = Light-Heavy, H = Heavy, EH = Extra-Heavy  
 Dimensions are in inches [Dimensions in brackets are metric]

## Swivel Mounts

Join moving or non-parallel bundles with our swivel tie mount, keeping cables, tubing, and hoses separated and protected against abrasion.

### Key Features and Benefits

- The two mounts are securely fastened together with a connecting rivet that allows both mounts to rotate
- Can join bundles of cable, tubing, or hoses that may need to move or are not parallel
- Separates bundles to avoid abrasion
- Material: Weather-resistant Nylon 6.6

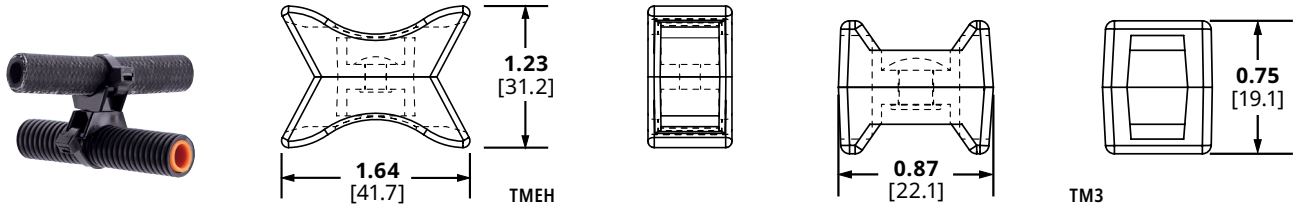

Dimensions are in inches. [Dimensions in brackets are metric].

Part Number	Used with Cable Ties†	Pull Apart Force Lbs. (g)	Color	Environment	Std. Pkg. Qty.	Std. Ctn. Qty.
TM3-X2-C0Y	M, I, S, HS, LH	120 (54,431)	Black	Indoor/Outdoor	100	1000
TMEH-X2-L0Y	M, I, S, HS, LH, H, EH	250 (113,398)			50	500

## Cable Spacer

Cable spacers are designed to accommodate hoses or cable bundles while maintaining separation. The spacers work with cable ties up to heavy cross section.

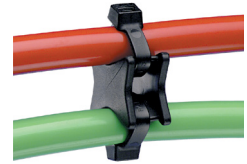

### Key Features and Benefits

- Designed to maintain precise cable separation, ensuring proper cable alignment and reducing the risk of electrical faults
- Constructed from durable, high-quality materials for long-lasting performance in demanding environments
- Easy installation process that helps save time and labor during cable management setup
- UV-resistant and suitable for both indoor and outdoor applications, providing flexibility for various installation needs

Part Number	Color	Height In. (mm)	Length In. (mm)	Width In. (mm)	Environment	Maximum Continuous Use Temperature	Std. Pkg. Qty.	Std. Ctn. Qty.
CSEH15A30-C0	Black	1.18 (30)	1.57 (39.9)	0.79 (20)	Indoor	-76°F - 185°F (-60°C - 85°C)	100	1000

### Pan-Clamp™ Heavy Duty Fixed Diameter Clamps

Engineered for secure, reliable support of cables, conduit, and tubing in demanding environments, Pan-Clamp Heavy Duty Fixed Diameter Clamps are manufactured with robust materials and deliver high mechanical strength and corrosion resistance making them ideal for both industrial and commercial applications. They are designed for easy installation, consistent clamping force, and stable alignment, supporting long-term system performance.

#### Key Features and Benefits

- One-piece design significantly reduces installation time
- Integrated ribs prevent rotation of cable bundles and ensures secure grip on hoses
- Material: Impact-modified, weather-resistant Nylon 6.6

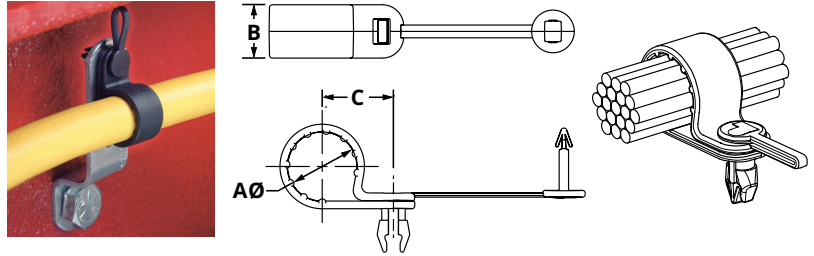

Part Number	Max. Bundle Diameter A In. (mm)	Width B In. (mm)	Bundle Offset C In. (mm)	Max. Panel Thickness In. (mm)	Panel Hole Diameter In. (mm)	Color	Std. Pkg. Qty.	Std. Ctn. Qty.
PC038-H25D-C0	0.38 (9.5)	0.62 (15.7)	0.64 (16.3)	0.125 (3.2)	0.281 (7)	Black	100	500
PC050-H25D-C0	0.50 (12.7)		0.71 (17.9)					
PC062-H25D-C0	0.63 (15.8)		0.77 (19.5)					
PC075-H25D-C0	0.75 (19.1)		0.83 (21.1)					
PC087-H25D-C0	0.87 (22.1)		0.89 (22.7)					1000
PC100-H25D-C0	1.20 (30.5)		0.96 (24.3)					
PC112-H25D-C0	1.33 (33.8)		1.02 (25.8)					
PC125-H25D-C0	1.45 (36.8)		1.08 (27.4)					



# Fir Tree Push Mounts

Designed to be installed in a pre-drilled panel hole, Fir Tree Push Mounts create an anchor point for securing wire bundles and harnesses.

## Key Features and Benefits

- Unique alternating barb design
- Lock securely into position
- Umbrella tensioning
- Exclusive contoured anvil head
- Material: Heat-stabilized Nylon 6.6
- Heavy-duty fir tree mount for use with wide strap cable ties

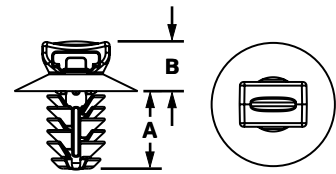
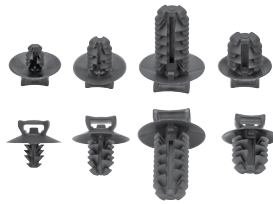

Part Number	Used with Cable Ties‡	Material	Head Diameter In. (mm)	Panel to Top Mount In. (mm)	Overall Height In. (mm)	Panel Hole Diameter Range In. (mm)	Panel Thickness Range In. (mm)	Std. Pkg. Qty.	Std. Ctn. Qty.
PUM-049-M30		Heat-stabilized, weather-resistant Nylon 6.6	0.65 (16.5)	0.26 (6.6)	0.54 (13.8)	0.18 – 0.19 (4.6 – 4.9)	0.03 – 0.12 (0.7 – 3.0)	1000	5000
PUM-071-M30	M, I, S				0.67 (16.9)	0.25 – 0.28 (6.3 – 7.1)	0.03 – 0.28 (0.8 – 7.0)		
PUM-100-M30			0.64 (16.2)	0.35 – 0.40 (9.0 – 10.0)					
PUM-925-M30	M, I, S, LH		0.77 (19.6)	1.05 (26.7)					
PUME925-D350	M, I, S, LH, H, EH	Impact-modified, heat-stabilized, weather-resistant Nylon 6.6	0.77 (19.5)	0.395 (10.0)	1.15 (29.1)	0.34 – 0.36 (8.8 – 9.3)	0.04 – 0.63 (1.0 – 16.0)	500	

‡Cable Tie Cross Section Sizes: M = Miniature, I = Intermediate, S = Standard, LH = Light-Heavy, H = Heavy, and EH = Extra Heavy

### Fir Tree Push Mount Assemblies

Secure your wire harnesses with the push mount assembly. Ideal for automotive, marine, and heavy equipment, this mount offers increased retention and lower insertion force.

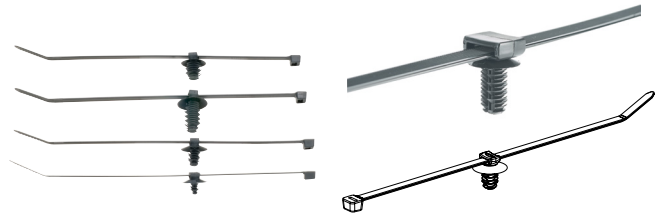

#### Key Features and Benefits

- Pre-assembled cable tie/mount combinations reduce installation time versus selecting and assembling separate components
- Assembly-style parts reduce the number of individual items to pick, stage, and track during manufacturing and installation
- Fir tree push-mount designs support easy insertion into a pre-drilled hole while providing secure retention in the panel

Part Number	Material	Head Diameter In. (mm)	Panel to Top Mount In. (mm)	Overall Height In. (mm)	Panel Hole Diameter Range In. (mm)	Panel Thickness Range In. (mm)	Maximum Bundle Diameter In. (mm)	Std. Pkg. Qty.	Std. Ctn. Qty.
PUM-049-2S-D30 <sup>^</sup>	Heat-stabilized, weather-resistant Nylon 6.6	0.65 (16.5)	0.26 (6.6)	0.54 (13.8)	0.18 – 0.19 (4.6 – 4.9)	0.03 – 0.12 (0.7 – 3.0)	1.88 (48.0)	500	5000
PUM-071-2S-D30 <sup>^</sup>				0.67 (16.9)	0.25 – 0.28 (6.3 – 7.1)	0.03 – 0.28 (0.8 – 7.0)			
PUM-100-2S-D30 <sup>^</sup>		0.64 (16.2)	0.35 – 0.40 (9.0 – 10.0)						
PUM-925-3H-T30 <sup>^^</sup>	Impact-modified, heat-stabilized, weather-resistant Nylon 6.6	0.77 (19.6)	0.26 (6.6)	1.05 (26.7)	0.34 – 0.36 (8.8 – 9.3)	0.04 – 0.63 (1.0 – 16.0)	3.00 (76.0)	200	1000
PUME925-3E-C350 <sup>*</sup>		0.77 (19.5)	0.395 (10.0)	1.15 (29.1)	0.34 – 0.36 (8.8 – 9.3)		3.25 (82.6)	100	
PUME925-4E-C350 <sup>*</sup>						4.13 (105)			

<sup>^</sup>Includes PLT2S cable ties, <sup>^^</sup>Includes PLT3H cable ties, <sup>\*</sup>Includes wide strap PLWSXXX-TL350 cable ties

# Edge Clips

## Edge Clip Cable Tie Mounts

Edge clip cable tie mounts help secure wire and cable bundles with versatile mounting to edges. Panduit heavy duty cable ties and mounts are made of rugged, highly durable materials; ideal for automobiles, trains, heavy equipment, trucks, and solar applications.

### Key Features and Benefits

- Versatile cable tie mount provides horizontal or vertical mounting
- High performance metal clip delivers high pull off force yet still allows for easy hand installation, without the need for tools
- Extended range from 0.7mm – 3mm edge thicknesses as well as a larger clip offering for 3mm – 6mm edge thicknesses
- The cable tie mount saddle provides close fit for small diameter bundles



Part Number	Saddle Fixation (for anchoring cable tie)	Flange Thickness	Bundle Orientation	Style	Cable tie and/or compatible cross section
CME12-M300	Edge-fixed (E)	0.7mm – 3mm (12)	Parallel (A) or Perpendicular (B)	Mount only	M, I, S
CME24-M300		3mm – 6mm (24)			
CMS12-M300	Side-fixed (S)	0.7mm – 3mm (12)			
CMS24-M300		3mm – 6mm (24)			



## Edge Clip Mount Assemblies

Edge Clip Mount Assemblies are designed for quick and secure attachment of cable ties to the edges of panels or enclosures, without the need for holes or adhesives. These assemblies are ideal for routing and managing cables in tight spaces, offering a reliable solution for various industrial and commercial applications.

### Key Features and Benefits

- Reduces installation time compared to loose parts
- Fewer parts throughout the manufacturing/assembly process



Part Number	Saddle Fixation (for anchoring cable tie)	Flange Thickness	Bundle Orientation	Style	Cable tie and/or compatible cross section
CMEA12-2S-D300	Edge-fixed (E)	0.7mm – 3mm (12)	Parallel (A)	Cable tie assembly	PLT2S-300
CMEA24-2S-D300		3mm – 6mm (24)			
CMSA12-2S-D300	Side-fixed (S)	0.7mm – 3mm (12)	Perpendicular (B)		
CMSA24-2S-D300		3mm – 6mm (24)			
CMEB12-2S-D300	Edge-fixed (E)	0.7mm – 3mm (12)			
CMEB24-2S-D300		3mm – 6mm (24)			
CMSB12-2S-D300	Side-fixed (S)	0.7mm – 3mm (12)			
CMSB24-2S-D300		3mm – 6mm (24)			

## Stud Mounted Cable Ties – Heat-Stabilized and Heat-Stabilized, Weather-Resistant Nylon 6.6

Stud mount cable ties keep cables organized and secure on any surface. Simple to attach and remove, these cable ties withstand heat and UV exposure. Perfect for use in data centers and factories.

### Key Features and Benefits

- Heat-stabilized material for high-temperature applications up to 239°F (115°C) — indoor use
- Tie can be removed from the stud by turning counterclockwise
- Releasable style available (PRST)
- Curved tip is easy to pick up from flat surfaces and allows faster initial threading to speed installation

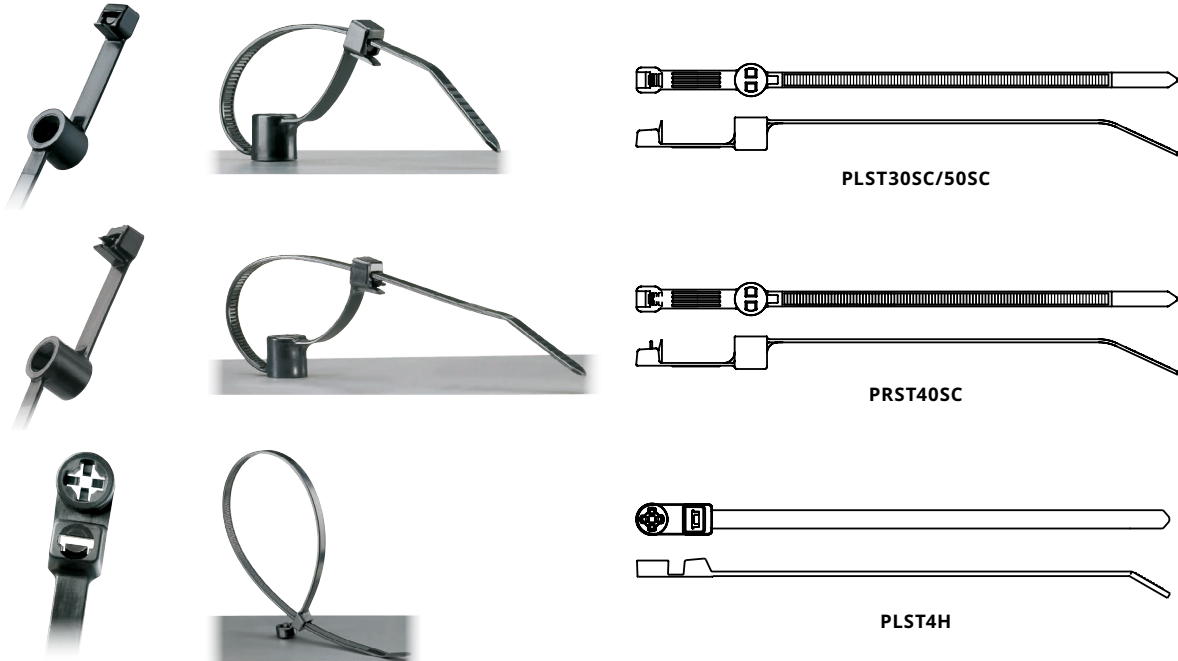

Part Number	Length In. (mm)	Width In. (mm)	Thickness In. (mm)	Recommended Stud Size In. (mm)	Max. Bundle Dia. In. (mm)	Min. Loop Tensile lbs. (N)	Recommended Installation Tool	Std. Pkg. Qty.	Std. Ctn. Qty.
<b>HEAT-STABILIZED NYLON 6.6 STANDARD CROSS SECTION</b>									
PLST30SC-D30	5.7 (146)				1.18 (30)		GTS-E, GS2B-E, GTHE, GS4H-E, PTS, PTH, PLST50SC-D30		
PLST50SC-D30	8.1 (207)	0.190 (4.8)	0.050 (1.3)	10–24 (5.0)	1.97 (50)	50 (222)	8.1 207 0.190 4.8 0.050 1.3 10–24 5.0 1.97 50 PPTS, STS2, STH2	500	5000
PRST40SC-D30	6.9 (176)				1.57 (40)		Hand install only		
<b>HEAT-STABILIZED, WEATHER-RESISTANT NYLON 6.6 LIGHT-HEAVY CROSS SECTION</b>									
PLST4HS25-TL300	15.3 (389)	0.3 (7.6)	0.075 (1.9)	1/4–20 (6.4)	4.0 (102)	120 (534)	GTH-E, GS4H-E, GS4EH-E, PTH, STH2, ST3EH	250	2500

Note: UL Recognized and CSA Certified except PLST4H

# Cable Tie Installation Hand Tools

Ergonomic series of hand-operated, tool-controlled tension, and cut-off cable tie installation tools are the most preferred hand-operated tools in the industry. These versatile tools can be used for production, maintenance, or construction applications. The ergonomic series of tools is excellent for low to medium volume applications (under 50,000 ties/year) and promote worker safety, help reduce downtime, improve productivity and provide the lowest total installed cost.

## Key Features and Benefits

- Beveled tie entry allows quick side entry of tie into tool to speed installation
- Easy-to-read tension-setting label eliminates guesswork
- Long, narrow nose improve installer’s visibility and access to confined areas
- Slip-proof, soft handle and rear grip cushions the fingers and hand during operation
- Hanger hook allows tool to be easily stored



Part Number	Used with Cable Ties	Weight Oz. (g)	Part Features	Standards	Std. Pkg. Qty.
GTS-E	SM, M, I, S	10.4 (294)	Manual-operated tool. Impact resistant resin housing, dark gray color. Black-colored trigger handle, cushion handle and tension selector knob.	QPL per Mil. Std. SAE AS81306 and Mil. Spec SAE AS90387	1
GS2B-E	SM, M, I, S	13.6 (385.6)	Manual-operated tool. Metal housing, light gray color. Black-colored trigger handle, cushion handle and tension selector knob.	Mil. Spec. Part Number MS90387-1	
GTH-E	S, HS, LH, H, EH (thin*)	11.9 (337)	Manual-operated tool. Impact resistant resin housing, dark gray color. Red-colored trigger handle, cushion handle and tension selector knob.	QPL per Mil. Std. SAE AS81306 and Mil. Spec. SAE AS90387	
GS4H-E	S, HS, LH, H	15.4 (435)	Manual-operated tool. Metal housing, light gray color. Red-colored trigger handle, cushion handle and tension selector knob.	Mil. Spec. Part Number MS90387-2	
GS4EH-E	LH, H, EH		Manual-operated tool. Metal housing, light gray color. Blue-colored trigger handle, cushion handle and tension selector knob.	Mil. Spec. Part Number MS90387-4	
PTS	SM, M, I, S	17.3 (490)	Pneumatic-operated tool. Impact resistant resin housing, dark gray color. Black-colored trigger, cushion handle and tension selector knob.	N/A	
PTH	S, HS, LH, H	32.0 (907)	Pneumatic-operated tool. Impact resistant housing, dark gray color. Red-colored trigger, cushion handle and tension selector knob.		



GTS-E



GS2B-E



GTH-E



GS4H-E



GS4EH-E



PTS



PTH

Cable tie cross section sizes: SM = Subminiature, M = Miniature, I = Intermediate, S = Standard, HS = Heavy Standard, LH = Light Heavy, H = Heavy, EH = Extra-Heavy. Note: All pneumatic hand tools require the PPH10 hose and PL289N1 filter/regulator for proper operation.

\*GTH-E tools starting with Date Code L18 now cut through Extra-Heavy thin ties (PLWS2EH, PLWS3EH, PLWS4EH, PLDC1.5EH, PLDC2.5EH). Date Code is etched on the red trigger handle. These tools come equipped with a wider blade that will cut through these Extra-Heavy thin ties. Tools prior to the L18 date code do not come with the wide blade and will not cut these ties.

# Complete Your Bundle

## Cable Ties

Cable ties are designed to exceed industry standards for use in high-vibration areas. Available in a wide range of materials, styles and sizes to meet your internal and external temperature applications.



### Key Features and Benefits

- External tooth design on select styles for improved abrasion-resistance to wires, cables and hoses
- Metal barb styles for added tensile strength and increased bundle diameter variations
- Push mount and fir tree barb style ties for specialty applications
- Unique designs, such as wide strap and dual-clamp ties, improve reliability and productivity

## Cable Accessories

Mounts and other devices help secure wire, cable and hose bundles – making installation more efficient and cost effective.



### Key Features and Benefits

- Installation styles, such as push barb, stud mount and bolt/screw, help tailor cable routing and management
- Adhesive options for mounting to surfaces in interior and exterior applications
- Most styles are available in a variety of materials for high temperature, UV resistant and general purpose applications

## Stainless Steel Cable Ties

Stainless-steel cable ties can bundle, fasten and secure cables and hoses that are exposed to corrosive or harsh conditions. Ties are built to last, helping reduce periodic rework.



### Key Features and Benefits

- Self-locking cable ties enable faster installation
- Fully coated ties help prevent corrosion between dissimilar metals
- Smooth surfaces and rounded edges protect the cable bundle and the installer for improved safety, productivity and reliability

## Cable Identification

Complete labeling systems – including time-saving labeling software, easy to use printers, high-end metal marker plates and heat shrink labels – help minimize installation time and ensure high-quality wire and cabling identification in demanding environments.



### Key Features and Benefits

- Software simplifies label creation
- Outdoor rated and water-resistant label options
- Handheld and desktop printers allow for fast and high-quality label production
- Custom, imprinted cable ties available in multiple styles, sizes and colors

## Abrasion Protection

A broad range of abrasion protection products for wire, cable and tubing meet your unique application requirements and today's most demanding safety standards.



### Key Features and Benefits

- Braided, expandable sleeving fully covers wires while allowing heat dissipation
- Spiral wrap creates bundles to provide protection

## Power Connectors and Grounding

Copper and aluminum compression connectors and mechanical connectors provide critical electrical grounding and reliable wire terminations.



### Key Features and Benefits

- Compression and mechanical lugs and splices designed for demanding power applications

**Panduit Battery Compression Lugs** provide OEM quality termination for Heavy Duty power connector applications. The Panduit BCL products are part of a complete offering of power connectors, lugs and tooling to provide a complete solution.



We have the knowledge  
and experience to help you  
make the most of your  
infrastructure investment.

**panduit.com**



**Let's connect**  
[panduit.com/contact-us](https://panduit.com/contact-us)

**PANDUIT™**

infrastructure for a connected world