

Ground Plates

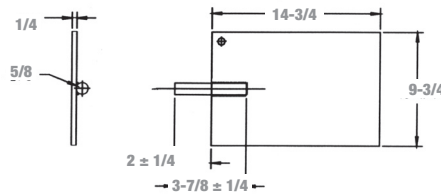

Galvanized Grounding Plates

- Made of high-quality steel, hot dip galvanized
- Major time and cost savings vs ground rods



Cat. No.	Description	Wire Range	Std. Pkg.
1016TB	Galvanized grounding plate	8 sol. to 3/0 str.	1
1016BTB	Galvanized grounding plate (complete with JAB34C connector)		

Ground Electrode Boxes



Cat. No.	Description
51628	Pregalvanized steel
51629	Hot dip galvanized steel
51628-ALTA	Ground electrode box for Alberta only

14 gauge steel 10 in. diameter, 12 in. depth.

Metallic Gradient Control Mats

- To reduce risk and prevent build up of dangerous potential differences between high-voltage equipment or structures and the user standing on the ground surface. CEC Rule 36-308.

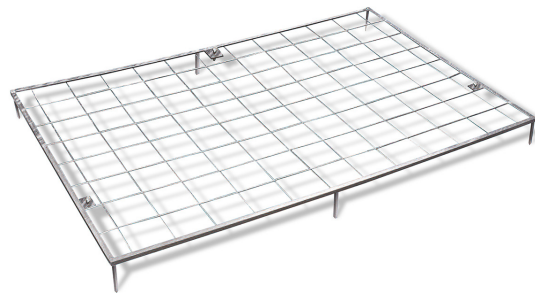

Cat. No.	Description	Std. Pkg.	Wt/100	
			lb.	kg
64663	Mat with hardware	1	3000	1363

4 ft. x 6 ft. hot dip galvanized mat is made from 6 in. x 6 in. welded mesh. 1/4 in. diameter. With hardware 3-1/2 x 1/2 galvanized bolts, 3 gal. washers and 3 gal. nuts. Custom ground mat also available upon request.

Ground Plates

Type GP — Copper Pole Bottom Ground Plates for Multigrounded Neutral Construction

- More efficient than butt wrapping poles
- Made of electrolytic sheet copper
- Built-in high-pressure connector for ground lead, or supplied with #6 AWG copper pigtail pre-attached
- Plates are grooved for trapping moisture



Cat. No.	Pigtail Wire Range				Diameter of Plate	
	Min.	Max.	Min. (mm ²)	Max. (mm ²)	(in.)	(mm)
GP100	8	2 sol.	6.3	25.6	7-1/2	191
GP110					10	254
GP114					14	356
GP1003					7-1/2	191
GP1008	#6 AWG solid Cu Pigtail with 18 in. conductor		-	-	7-1/2	254
GP1108						

Type PB — Copper Pole Ground Plates

- Installed on butt end of utility poles to provide an economical, low resistance neutral ground
- Installed cost considerably less than butt-wrapped poles. Plate portion fabricated of 0.025 in. pure copper
- PBGW connector is eye-bolt type, cast of corrosion resistant aluminum bronze alloy, with silicon bronze nut and lock washer. Riveted all copper terminal lug is an integral part of the PBH, and provides the means of connection to the grounding conductor



Cat. No.	Wire Range		Finished Size (in.)	Surface Area (sq. in.)
	Max.	Min.		
PBGW	2/0 str.	10 sol.	7 x 7-5/8	56
PBH*	4 str.	14 sol.		

* RUS Listed.