

Fitting Number Selection

Aluminum Cable Tray

Fittings in a cable tray system are required to change cable routing direction and to join straight sections and other fittings.

This step of the cable tray selection process requires that the specifier chooses between two distinct styles U and H.

Note: The U-Style and H-Style systems are interchangeable.

U-Style Fitting

A U-shaped extrusion forms the fitting siderail. U-Style fittings utilize a 7" splice plate and the fittings have tangents at the extremities. This style offers maximum quality versus cost ratios of the installation.

H-Style Fitting

An H-shaped extrusion forms the fitting siderail. H-Style fittings utilize a 7" splice plate and the fittings have 3" tangents at the extremities. This style offers enhanced aesthetics to the end-user and increased system rigidity.

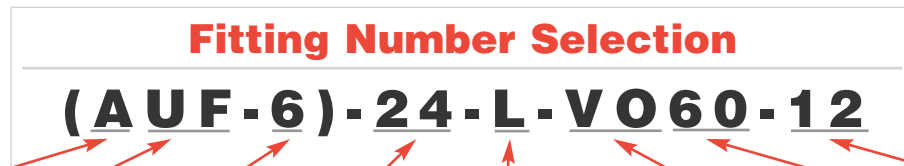

| Fitting Material | Fitting Style | Siderail Depth | Width | Bottom Type | Fitting Type | ** Angle | † Nominal Radius |
|---------------------|--|--|---|---|---|--|--|
| A • Aluminum | UF • U-Beam HF • H-Beam | 4 • (4") 5 • (5") 6 • (6") 7 • (7") | 06 • (6") 09 • (9") 12 • (12") 18 • (18") 24 • (24") 30 • (30") 36 • (36") | * L • Ladder *** V • Ventilated **** S • Solid Trough | HB • Horizontal Bend HT • Horizontal Tee HX • Horizontal Cross VI • Vertical Inside Bend VO • Vertical Outside Bend VTD • Vertical Tee Down VTU • Vertical Tee Up HYR • Horizontal Wye Right HYL • Horizontal Wye Left RT • Horizontal Reducing Tee ET • Horizontal Expanding Tee EX • Horiz. Expand Cross HLR • Horizontal Left Reducer HSR • Horizontal Straight Reducer HRR • Horizontal Right Reducer CS • Cable Support Fitting | 30 • (30°) 45 • (45°) 60 • (60°) 90 • (90°) | 12 • (12") 24 • (24") 36 • (36") 48 • (48") |

** Angle is required for HB, VI, VO only.
† Radius is not required for the following Fitting Types: **HYR, HYL, HLR, HRR, HSR**

* Manufactured with 9" rung spacing measured at the center line of fitting.
*** Manufactured with 4" edge to edge rung spacing measured at the center line of fitting.
**** Manufactured with flat sheet inserted under rungs with 9" rung spacing measured at the center line of fitting.

Aluminum Cable Tray

U-Style Fittings Horizontal Tee, Cross

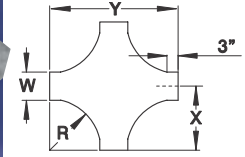
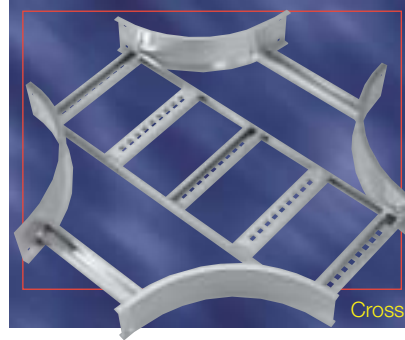
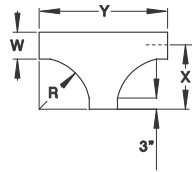
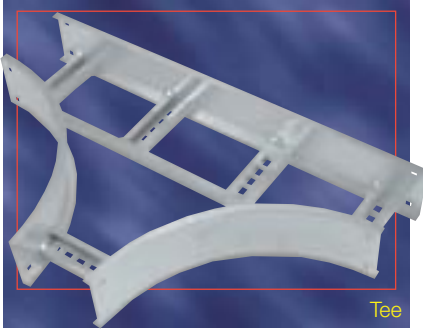

Part Numbering System

AUF-5-06-L-HT-12

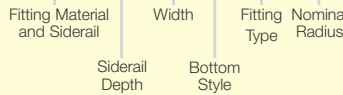

Selection Guide

Inside Tray Widths: 6, 9, 12, 18, 24, 30, 36
Nominal Radius: 12, 24, 36, 48
Bottom Styles: L- Ladder, V- Ventilated, S- Solid
Side Rail Depth: 4"- 7"

Technical Specifications

Horizontal TEE – U-Style

| Nominal Radius R | Width | Catalogue Number | Dimensions | |
|---------------------|-------|--------------------|------------|-----|
| | | | X | Y |
| 12 | 6 | AUF(†)-06-(*)-HT12 | 15 | 30 |
| | 9 | AUF(†)-09-(*)-HT12 | 16-1/2 | 33 |
| | 12 | AUF(†)-12-(*)-HT12 | 18 | 36 |
| | 18 | AUF(†)-18-(*)-HT12 | 21 | 42 |
| | 24 | AUF(†)-24-(*)-HT12 | 24 | 48 |
| | 30 | AUF(†)-30-(*)-HT12 | 27 | 54 |
| 24 | 36 | AUF(†)-36-(*)-HT12 | 30 | 60 |
| | 6 | AUF(†)-06-(*)-HT24 | 27 | 54 |
| | 9 | AUF(†)-09-(*)-HT24 | 28-1/2 | 57 |
| | 12 | AUF(†)-12-(*)-HT24 | 30 | 60 |
| | 18 | AUF(†)-18-(*)-HT24 | 33 | 66 |
| | 24 | AUF(†)-24-(*)-HT24 | 36 | 72 |
| 36 | 30 | AUF(†)-30-(*)-HT24 | 39 | 78 |
| | 36 | AUF(†)-36-(*)-HT24 | 42 | 84 |
| | 6 | AUF(†)-06-(*)-HT36 | 39 | 78 |
| | 9 | AUF(†)-09-(*)-HT36 | 40-1/2 | 81 |
| | 12 | AUF(†)-12-(*)-HT36 | 42 | 84 |
| | 18 | AUF(†)-18-(*)-HT36 | 45 | 90 |
| 48 | 24 | AUF(†)-24-(*)-HT36 | 48 | 96 |
| | 30 | AUF(†)-30-(*)-HT36 | 51 | 102 |
| | 36 | AUF(†)-36-(*)-HT36 | 54 | 108 |
| | 6 | AUF(†)-06-(*)-HT48 | 51 | 102 |
| | 9 | AUF(†)-09-(*)-HT48 | 52-1/2 | 105 |
| | 12 | AUF(†)-12-(*)-HT48 | 54 | 108 |
| | 18 | AUF(†)-18-(*)-HT48 | 57 | 114 |
| | 24 | AUF(†)-24-(*)-HT48 | 60 | 120 |
| | 30 | AUF(†)-30-(*)-HT48 | 63 | 126 |
| | 36 | AUF(†)-36-(*)-HT48 | 66 | 132 |

Horizontal CROSS – U-Style

| Nominal Radius R | Width | Catalogue Number | Dimensions | |
|---------------------|-------|--------------------|------------|-----|
| | | | X | Y |
| 12 | 6 | AUF(†)-06-(*)-HX12 | 15 | 30 |
| | 9 | AUF(†)-09-(*)-HX12 | 16-1/2 | 33 |
| | 12 | AUF(†)-12-(*)-HX12 | 18 | 36 |
| | 18 | AUF(†)-18-(*)-HX12 | 21 | 42 |
| | 24 | AUF(†)-24-(*)-HX12 | 24 | 48 |
| | 30 | AUF(†)-30-(*)-HX12 | 27 | 54 |
| 24 | 36 | AUF(†)-36-(*)-HX12 | 30 | 60 |
| | 6 | AUF(†)-06-(*)-HX24 | 27 | 54 |
| | 9 | AUF(†)-09-(*)-HX24 | 28-1/2 | 57 |
| | 12 | AUF(†)-12-(*)-HX24 | 30 | 60 |
| | 18 | AUF(†)-18-(*)-HX24 | 33 | 66 |
| | 24 | AUF(†)-24-(*)-HX24 | 36 | 72 |
| 36 | 30 | AUF(†)-30-(*)-HX24 | 39 | 78 |
| | 36 | AUF(†)-36-(*)-HX24 | 42 | 84 |
| | 6 | AUF(†)-06-(*)-HX36 | 39 | 78 |
| | 9 | AUF(†)-09-(*)-HX36 | 40-1/2 | 81 |
| | 12 | AUF(†)-12-(*)-HX36 | 42 | 84 |
| | 18 | AUF(†)-18-(*)-HX36 | 45 | 90 |
| 48 | 24 | AUF(†)-24-(*)-HX36 | 48 | 96 |
| | 30 | AUF(†)-30-(*)-HX36 | 51 | 102 |
| | 36 | AUF(†)-36-(*)-HX36 | 54 | 108 |
| | 6 | AUF(†)-06-(*)-HX48 | 51 | 102 |
| | 9 | AUF(†)-09-(*)-HX48 | 52-1/2 | 105 |
| | 12 | AUF(†)-12-(*)-HX48 | 54 | 108 |
| | 18 | AUF(†)-18-(*)-HX48 | 57 | 114 |
| | 24 | AUF(†)-24-(*)-HX48 | 60 | 120 |
| | 30 | AUF(†)-30-(*)-HX48 | 63 | 126 |
| | 36 | AUF(†)-36-(*)-HX48 | 66 | 132 |

(†) Insert side rail depth. (*) Insert bottom style to complete Catalogue Number.
 Tees include 2 pairs / Crosses include 3 pairs of splice plates with hardware.

T&B aluminum cable tray is composed of two distinct systems H-Style and U-Style. These systems are interchangeable.